

CERTIFICATE OF LOCATION OF GOVERNMENT CORNER

EAST QUARTER Corner of Section 11, Township 101 N., Range 40 W., 5th P.M.

STATE OF MINNESOTA, County of NOBLES

At the corner location shown on the sketch:

On 7/7/92 found on OLD ROTTED CORNER FENCE POST
DATE

left monument as found, lowered monument, removed monument (explain)

On 7/7/92 Placed a 3/4" X 24" REBAR WITH ALUMINUM CAP STAMPED
DATE "DNR SURVEY MARKER", UP 0.1' NEXT TO THE CORNER FENCE POST

SKETCH OF REFERENCE TIES

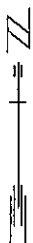

CULTIVATED

FIELD

NO TIES AVAILABLE

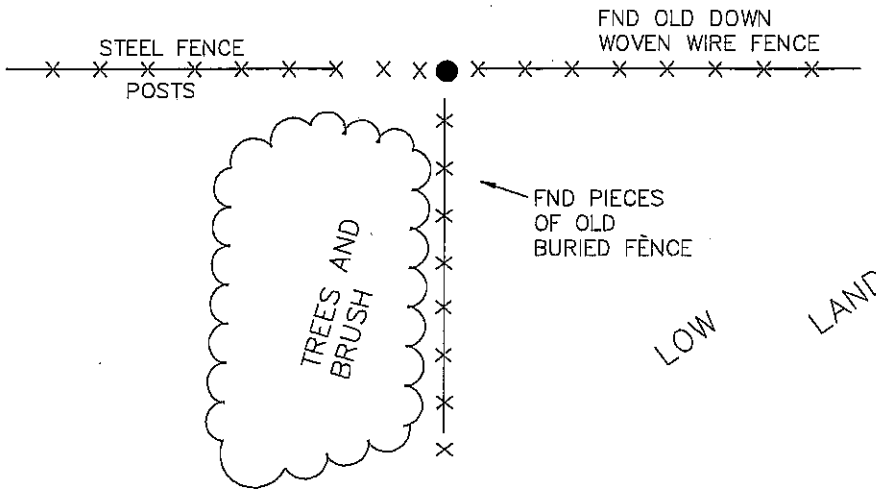

Statement of evidence relative to this corner location is on back of page.

7/15/92
WMA01400

I hereby certify that this document and the data contained herein was prepared by me or under my direct supervision.

Bruce W. Sheppard 7-24-92
SIGNATURE DATE

Registration No. 17003

- Land Surveyor, Professional Engineer
- County Surveyor, County Engineer

OFFICE OF THE COUNTY RECORDER
County of Nobles

I hereby certify that this document was filed in the Co. recorders office at 8:00 A.M. on the 31st day of July A.D., 1992
County Recorder Joyce Howard
By _____, Deputy
DOCUMENT NO. 248953

Tract 10-1-1 Comp. 10-1-1
Photo 10-1-1

East Quarter Corner Section 11, Township 101 North, Range 40 West, Page 1 of 2

The DNR Bureau of Engineering contacted the following for survey information:

Minnesota Secretary of State's Office
Nobles County Recorder's Office
Nobles County Highway Engineer's Office
Sioux Engineering of Windom
Madsen Land Surveying of Fairmont

1868 US General Land Office notes obtained from the Secretary of State's Office show the corner in a marsh. A witness corner was set 3.50 chains (231.00 feet) North and marked with a post in a mound with three pits.

1913 Surveyor's Record Book B, page 47, obtained from the County Recorder's Office contains a survey by William Saxon, County Surveyor. Survey shows a stone at corner but does not indicate if found or set. The corner is shown:

2660 feet from the east quarter corner of Section 11

2656 feet from a stone at the center of Section 11

No information is given about the witness corner.

1930 February, an unsigned Certificate of Location of Government Corner obtained from the County Highway Engineer's Office states that a stone was found at center of Section 11. The following ties were taken to the corner:

fence post, east, 24.7 feet

fence post, west, 23.2 feet

1936 US General Land Office notes for a survey of an island in Sections 1 and 2 obtained from the Secretary of State's office state that a small mound of earth was found at the witness corner. The mound was excavated and particles of a rotted stake, the grain of which was set vertically in the ground was found. Evidence of pits north, east and west was also found. A description of what was set to mark the witness corner is not given. The notes state that the quarter corner is in a wet marsh.

No An unsigned Certificate of Location of Government Corner obtained Date from the County Highway Engineer's Office contains a compilation of records in the Engineer's Office that pertain to this corner. The following is shown:

1913 - stone

East Quarter Corner Section 11, Township 101 North, Range 40 West, Page 2 of 2

No An unsigned Certificate of Location of Government Corner obtained
Date from the County Highway Engineer's Office contains a compilation of
records in the Engineer's Office that pertain to the center of
Section 11. The following is shown:

- 1913 - stone
- 1929 - stone
- 1961 - stake/iron pin

1992 July, DNR Bureau of Engineering found an old rotted off wooden
corner fence post with old downed woven and barbed wire east and
pieces of old buried fence south. Also, found a pile of field
stones next to and southeasterly of the corner fence post. Searched
around the corner fence post for a marked or a cut stone that could
have been set by a surveyor but did not find any. Found the area of
the witness corner to be in a cultivated field so a monument was
not searched for.

Visited the area of the center of Section 11 and found its location
to be in a 6 foot cut section of a north-south road with fences
east and west. Scanned the area with an electronic metal locator
but no metal attraction was obtained.

Set a DNR Survey Marker on the west side of the rotted corner fence
post and found it to be:

2647.15 feet from the centerline of the north-south road and
fences east- west found in the area of the center of
Section 11

2655.08 feet from the northeast corner of Section 14

Analysis of the above information led the DNR Bureau of Engineering to
conclude that the DNR Survey Marker set next to a rotted off corner
fence post marks the practical location of the corner.

