

CERTIFICATE OF LOCATION OF GOVERNMENT CORNER

SOUTH QUARTER Corner of Section 35, Township 101, Range 41, 5 P.M.

STATE OF MINNESOTA, County of NOBLES

At the corner location shown on the sketch:

- On Oct. 13, 1983 found a 10 inch by 16 inch by 22 inch granite stone
DATE
down 2.6 feet below bituminous surface.
 - left monument as found, lowered monument, removed monument (explain)
- On Oct. 13, 1983 placed a Minnesota Department of Transportation cast iron
DATE
monument with chiseled "+" on it. Down 0.2 feet below bituminous surface.

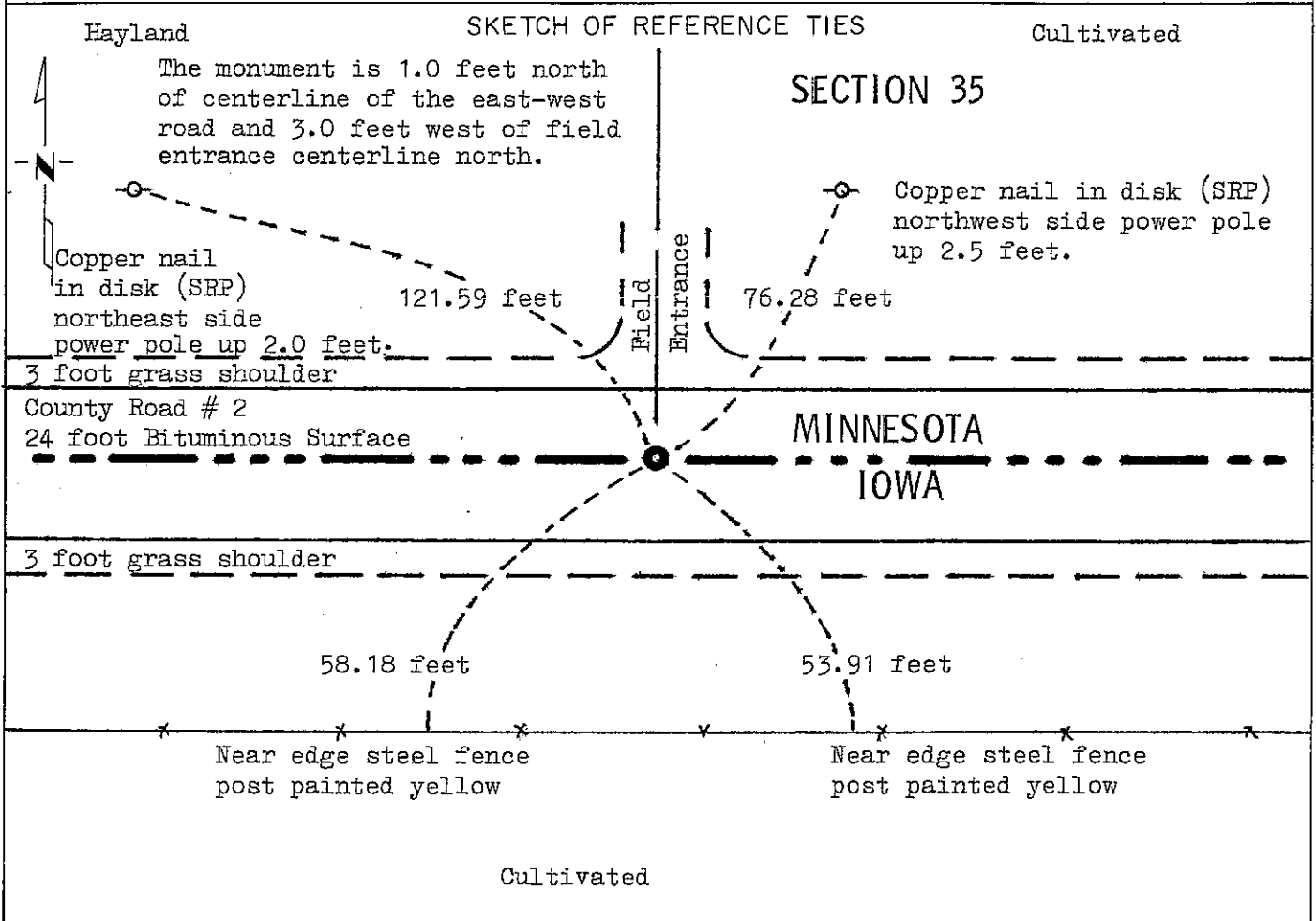

Statement of evidence relative to this corner location is on back of page.

I hereby certify that this document and the data contained herein was prepared by me or under my direct supervision.

S. Eldon Lober 2-4-83
SIGNATURE DATE

Registration No. 11933

- Land Surveyor, Professional Engineer
- County Surveyor, County Engineer

OFFICE OF THE COUNTY RECORDER

County of Nobles

I hereby certify that this document was filed in the Co. Recorders office at 4:10 P. M. on the 6th day of September A.D., 19 91

County Recorder James Howard

By _____, Deputy

DOCUMENT NO. 245395

Statement of Evidence: South Quarter 35 T101N R41W 5th P.M.

Aug. 7, 1852 Andrew Talcott, Surveyed the south boundary of Minnesota, his notes read, "Set $\frac{1}{4}$ Section Post in mound of earth & sod, with trenches & pits as per instructions." The survey originated at the Big Sioux river and ran from west to east.

Nobles County Highway land corners - - "Stone 1956" & placed "iron pin". Iron pin in 1958 and placed wood stake.

Oct. 13, 1982 Minnesota Department of Transportation field survey crew, using a tractor backhoe, dug for and found a granite stone, 10 inches east-west by 16 inches north-south by 22 inches high, with no visible markings. There was some rotten wood along the south-west side of the stone. The top of the stone was 2.6 feet below the bituminous surface. There were no occupation lines at this corner, so we used lost location methods to determine where to dig. The stone was found to be 1.30 feet north and 0.77 feet east of the lost location. I placed a Minnesota Department of Transportation cast iron monument directly over the middle of the stone.

An analysis of the Statement of Evidence and the field measurements indicate that the stone is in a reasonable location. I therefore accept the stone as the location of the land corner.

For additional information, including field measurements and photographs, contact the Minnesota Department of Transportation in Windom.

Tract 35 Compared See
 Photo 10-8
 Fee 710