

CERTIFICATE OF LOCATION OF GOVERNMENT CORNER

NORTH QUARTER Corner of Section 17, Township 102N, Range 39W, 5th P.M.

STATE OF MINNESOTA, County of NOBLES

At the corner location shown on the sketch:

- On _____ found a _____
DATE
- left monument as found, lowered monument, removed monument (explain)
- On Dec. 21, 1992 placed a Minnesota Department of Transportation Cast Iron
DATE
Monument down 2 feet below the surface.

SKETCH OF REFERENCE TIES

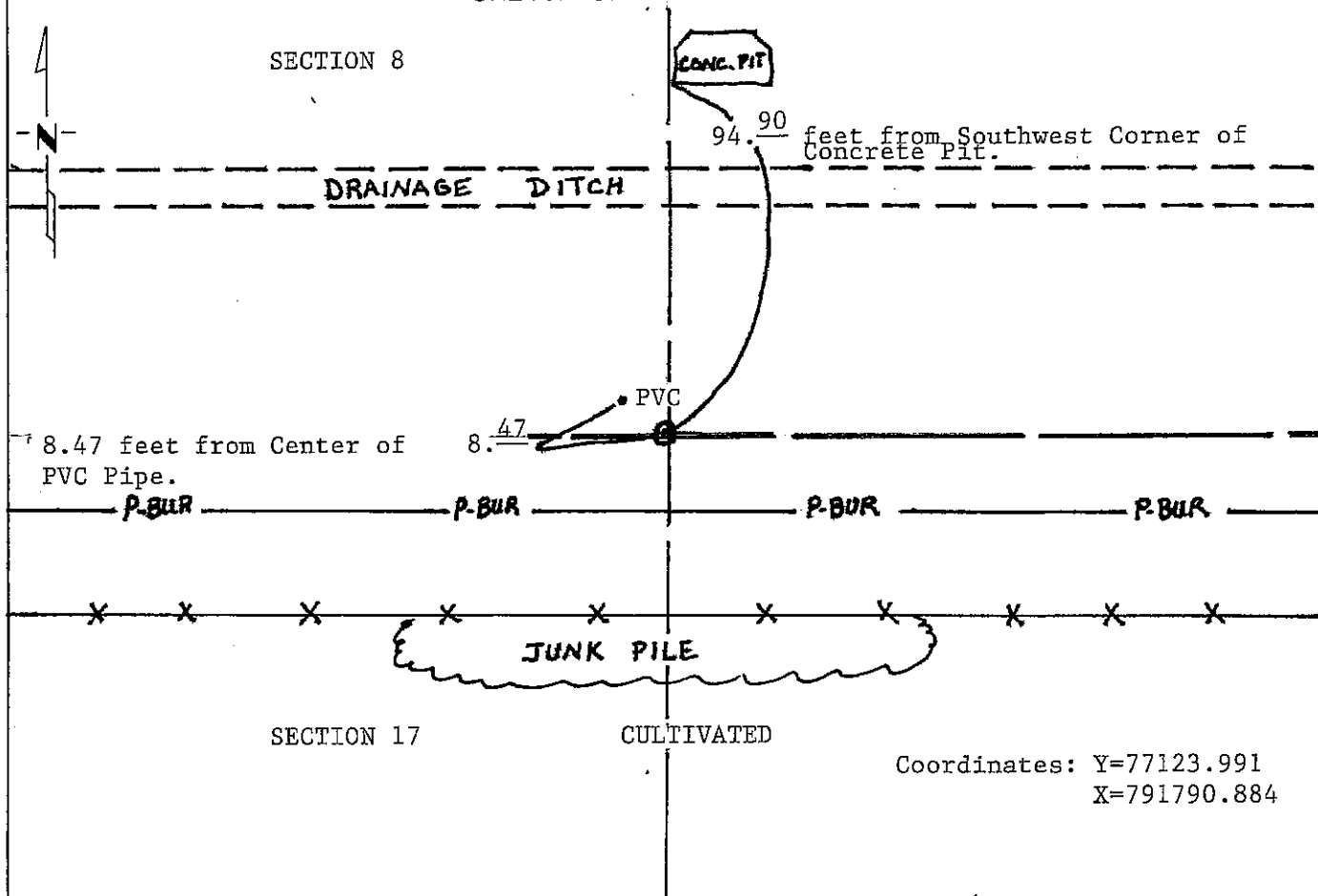

Statement of evidence relative to this corner location is on back of page.

I hereby certify that this document and the data contained herein was prepared by me or under my direct supervision.

Allan E. Schoon 1-07-93
SIGNATURE DATE

Registration No. 11858

- Land Surveyor, Professional Engineer
- County Surveyor, County Engineer

OFFICE OF THE COUNTY RECORDER
County of Nobles

I hereby certify that this document was filed in the Co. Recorders office at 8:50 A .M. on the 20th day of January A.D., 1993

County Recorder Joyce Howard

By _____, Deputy

DOCUMENT NO. 250857

Statement of Evidence: North Quarter Corner of Section 17, T102N, R39W, 5th P.M.

- Oct. 23, 1868 The original Public Land Survey was run in 1868 by Deputy Surveyor George G. Howe and his notes read, "Set post in mound with pits for $\frac{1}{4}$ section corner". (Quarter Corner is 39.98 chains from section corners.)
- Apr. 20, 1953 Ted Nystrom, Nobles County Surveyor, ran a survey in Section 8 and his plat indicates a stone at the corner.
- 1953 Nobles County Highway Records show a "stone" at the corner.
- Feb. 24, 1978 A Minnesota Highway Department survey crew consisting of Foster and Tessmer indicate in their notes "Site of corner not accessible at this time because of deep snow".
- Nov. 2, 1989 A Minnesota Department of Transportation survey crew consisting of Roger Busse, Dan Flatgard, Mike Murphy and Terry Makovsky, dug for the corner with a backhoe at the lost location site figured from the pipe at the Northeast Corner of Section 18-102-39. They dug a hole 5 feet south, 4 feet north, 13 feet east and 13 feet west of the lost location site with a depth of 4 feet. They found no evidence of the corner. The lost location site is about 16 feet north of the east-west fence line.
- Nov. 3, 1989 A Minnesota Department of Transportation survey crew consisting of Roger Busse, Dan Flatgard and Terry Makovsky, dug a hole 2 feet south, 4 feet north, 6 feet east and 8 feet west to a depth of about 4 feet at the lost location site figured from the coordinates for lost location of the Northeast Corner of Section 18-102-39. They found no evidence of the corner. This lost location site is about 13.7 feet south and 5.4 feet west of the lost location site established from the pipe at the Northeast Corner of Section 18-102-39.
- Dec. 21, 1992 A Minnesota Department of Transportation survey crew consistion of Deni Ernst, Deni Janke and Mike Murphy, placed a Minnesota Department of Transportation Cast Iron Monument at the lost location site computed from the accepted pipe monument at the Northeast Corner of Section 18-102-39 and the Northeast Corner of Section 17-102-39 coordinates.
- The lack of record and field evidence of the stone that was last located in 1953, indicates that this corner be set by lost methods, midway and on line between section corners.
- For additional information, including field measurements and photographs, contact the Minnesota Department of Transportation in Windom.