

CERTIFICATE OF LOCATION OF GOVERNMENT CORNER

EAST QUARTER Corner of Section 11, Township 102 N, Range 40 W, 5 P.M.

STATE OF MINNESOTA, County of NOBLES

At the corner location shown on the sketch:

- On June 30, 1980 found a 12 inch by 14 inch by 12 inch stone down 4.0 foot,
DATE
also found 8 inch by 8 inch by 10 inch stone down 2.0 foot and 1.0 foot south
 left monument as found, lowered monument, removed monument (explain)
- On Aug. 1, 1980 placed a Brass plug directly over lower stone.
DATE

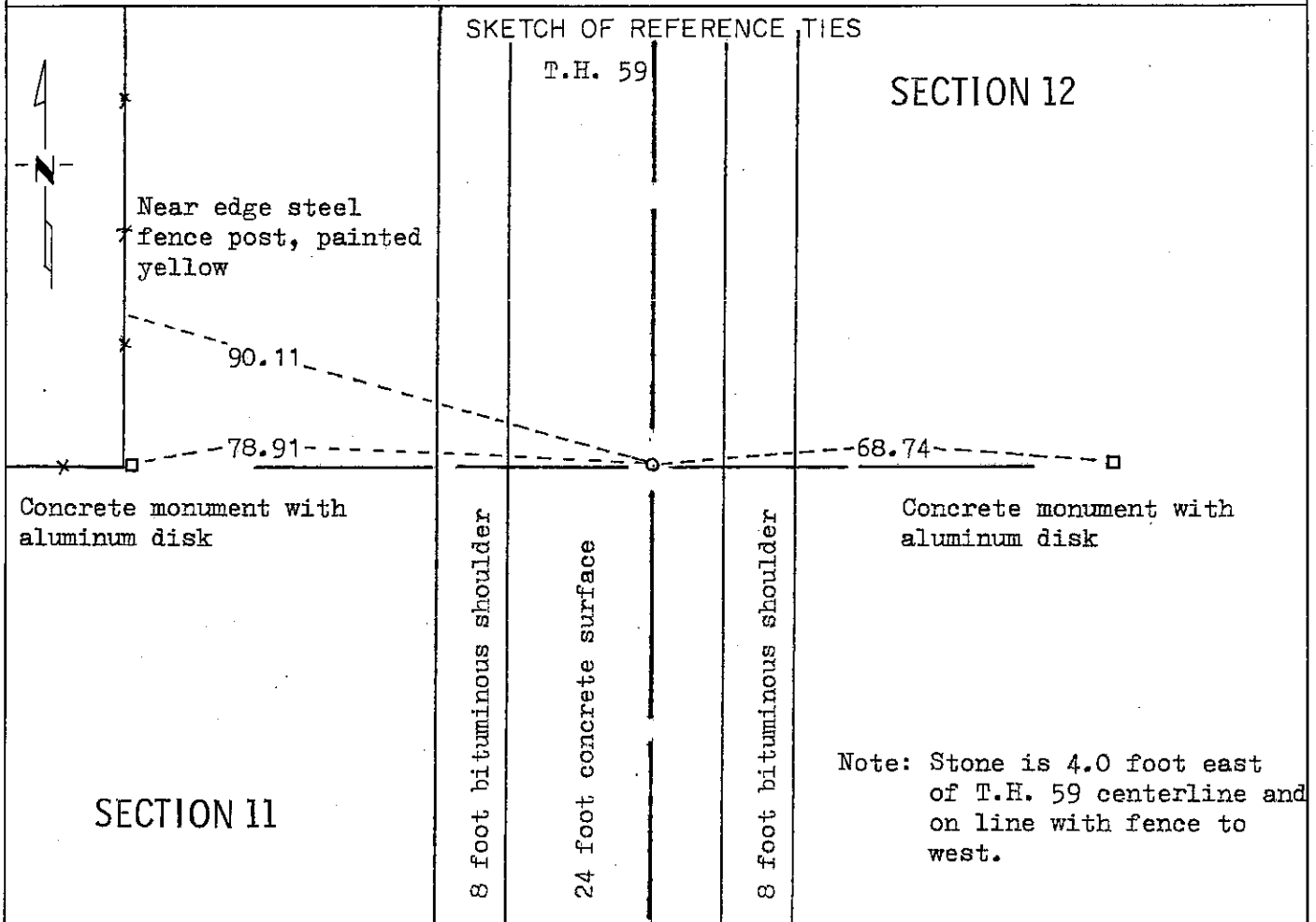

Statement of evidence relative to this corner location is on back of page.

I hereby certify that this document and the data contained herein was prepared by me or under my direct supervision.

Allan E. Schoon 10-15-92
SIGNATURE DATE

Registration No. 11858

- Land Surveyor, Professional Engineer
- County Surveyor, County Engineer

OFFICE OF THE COUNTY RECORDER

County of Nobles

I hereby certify that this document was filed in the Co. Recorders office at 9:10 A.M. on the 21st day of October A.D., 1992

County Recorder Jay Howard

By _____, Deputy

DOCUMENT NO. 249757

Statement of Evidence: East Quarter Corner of Section 11, T102N, R40W, 5th P.M.

- Sept. 25, 1868 The original Public Land Survey was run in 1868 by Deputy Surveyor G. G. Howe and his notes read, "Set post in mound with pits for $\frac{1}{4}$ Sec. Corner".
- 1890's A surveyor with the name of Moberly did a survey of Section 12 and his notes read, "Center of Section 12 was placed by intersection of lines from $\frac{1}{4}$ posts". Distance of 2652.2 from Center of Section 12 to East Quarter Corner of Section 11.
- May 23, 1894 Milton S. Smith, Nobles County Surveyor, made a survey in Section 12, he certifies that he, "set stone at the west quarter post." Distance is 2643.5 feet to section corners north and south.
- Oct. 17, 1903 M.S. Smith, Nobles County Surveyor, made a survey in Section 11. Does not mention type of monument, but distances are 2643.5 feet to Section corner "stones" north and south.
- 1954 Minnesota Highway Department right of way map indicates East Quarter of Section 11 is a "R.R. Stake".
- Feb. 27, 1980 Minnesota Department of Transportation survey crew found and tied in a brass plug that was probably placed in 1955.
- 1980 The concrete pavement on T.H. 59 was broken, removed and recycled. After pavement was removed the Minnesota Department of Transportation, of Windom, searched for the land corner.
- June 30, 1980 A Minnesota Department of Transportation survey crew using a tractor backhoe found an 8 inch by 8 inch by 10 inch stone down 2.0 feet below surface of gravel base, a 12 inch by 14 inch by 12 inch stone 4.0 feet below surface of gravel base and 1.0 foot north of shallower stone, the lower stone is 4 foot east of location of brass plug and on line with fence to west.
- Aug. 1, 1980 A Minnesota Department of Transportation survey crew placed a brass plug in the new concrete pavement at the location of the lower stone.
- The inplace location of the lower stone and brass plug is compatible with the occupation lines within the section. An analysis of the Statement of Evidence and field measurements indicate that the lower stone is in a reasonable location and probably is the stone set by M.S. Smith in 1894. I therefore accept the monument as the location of the land corner.
- For additional information, including field measurements and photographs, contact the Minnesota Department of Transportation in Windom.
- Dec. 12, 1991 Al Schafer, with the Minnesota Department of Transportation, and survey crew found the brass plug and reference ties.