

CERTIFICATE OF LOCATION OF GOVERNMENT CORNER
EAST QUARTER Corner of Section 13, Township 102N, Range 40W, 5th P.M.
 STATE OF MINNESOTA, County of NOBLES

At the corner location shown on the sketch:

- On Dec. 3, 1991 found a Minnesota Highway Department cast iron monument with a 3/4 inch iron pin below, monument is flush with grass surface.
DATE
 left monument as found, lowered monument, removed monument (explain)
- On _____ placed a _____
DATE

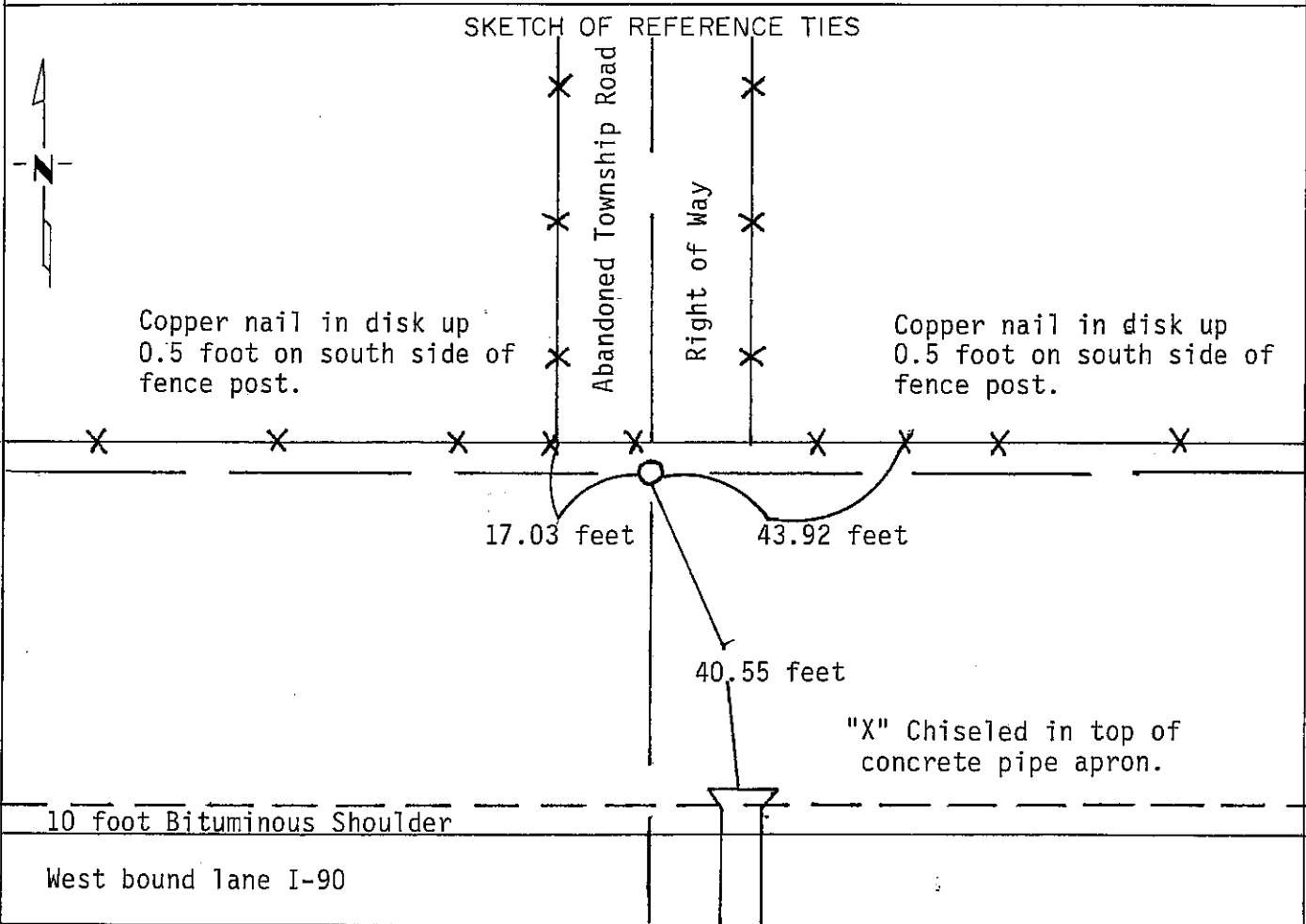

Statement of evidence relative to this corner location is on back of page.

I hereby certify that this document and the data contained herein was prepared by me or under my direct supervision.

Allan E. Schoon 10-15-92
SIGNATURE DATE
 Registration No. 11858
 Land Surveyor, Professional Engineer
 County Surveyor, County Engineer

OFFICE OF THE COUNTY RECORDER
County of Nobles

I hereby certify that this document was filed in the Co. Recorders office at 2:40 P. M. on the 22nd day of October A.D., 1992
 County Recorder Jayne Howard
 By _____, Deputy
 DOCUMENT NO. 249778

Statement of Evidence: East Quarter Corner of Section 13, T102N, R40W, 5th P.M.

- 1867 The original Public Land Survey of the Range Line between Ranges 39W and 40W was run in 1867 by Deputy Surveyor T.B. Walker, and his notes read, " $\frac{1}{4}$ sec. cor for which post in mound". (Charred stakes under all the mounds on this line).
- 1896 Nobles County Highway Department Records indicate stone in 1896, stone in 1914, stone 1959 and placed an iron pin.
- Apr. 21, 1902 Milton S. Smith, Nobles County Surveyor, did a survey in the Northeast Quarter of the section and a plat shows the East Quarter Corner is "Orig." and shows measurement of 1327.9 feet west to a sixteenth corner and 2655.8 feet west to the center section but does not describe monument.
- Oct. 29, 1914 Wm. A. Saxon, Nobles County Surveyor, notes read, "old stone" at east quarter corner measurement is 2652 feet from "old stone" section corner north and 2630 feet from "old stone" section corner south".
- June 19, 1934 Gebo, with the Minnesota Highway Department, notes from S.P. 5306 read, "True corner $W\frac{1}{4}$ corner Sec. 18-102-39 dug for found wedge shaped limestone about 6" long".
- 1959 Nobles County Highway Department Records indicate they placed an iron pin at the corner.
- Oct. 9, 1959 M.A. Sater, with the Minnesota Highway Department survey crew, notes from S.P. 5380-01 read, "Found rock down 3.0' with 1 x 2 above it. Pl. I.P. down 0.3'".
- June 24, 1969 George Koens survey crew chief, for the Minnesota Highway Department placed a Minnesota Highway Department cast iron monument over the rock and flush with the grass surface.
- June 17, 1980 Greg Windschitl and George Lober, with the Minnesota Department of Transportation, using a tractor backhoe, excavated a trench 6 feet north-south and 15 feet east-west, north of the northerly I-90 Right of Way fence, and an area within a 4 foot radius of the cast iron monument and found no evidence of any other monument.
- Dec. 3, 1991 John Brommer and survey crew, with the Minnesota Department of Transportation, found the Minnesota Highway Department cast iron monument and updated the ties.

The in-place location of the stone is compatible with the occupation lines within the section. An analysis of the Statement of Evidence and the field measurements indicate that the stone is in a reasonable location for the corner. I accept the in-place Minnesota Highway Department Cast Iron monument as the location of the land corner.

For additional information, including field measurements and photographs, contact the Minnesota Department of Transportation in Windom.