

# CERTIFICATE OF LOCATION OF GOVERNMENT CORNER

NORTH QUARTER Corner of Section 17, Township 102N, Range 40 W, 5th P.M.

STATE OF MINNESOTA, County of NOBLES

At the corner location shown on the sketch:

- On 6-26-84 found a 8"x8"x16" STONE, DOWN 14"  
DATE
- left monument as found,  lowered monument,  removed monument (explain)
- On 8-9-88 placed a 1 1/4"x 1 1/4"x 16" PERFORATED STEEL TUBE WITH ALUMINUM CAP STAMPED "DNR SURVEY MARKER", OVER STONE, DOWN 0.3'  
DATE

### SKETCH OF REFERENCE TIES

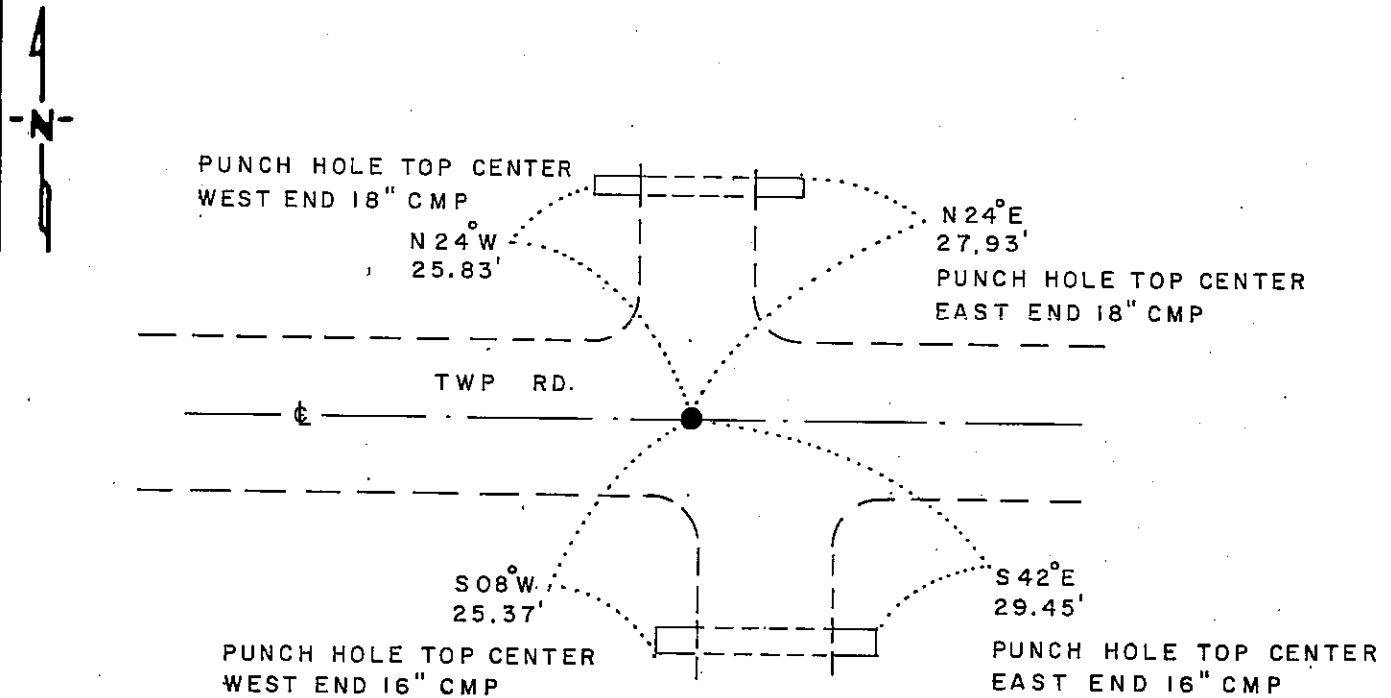

NOTE:  
MONUMENT IS  
ON  $\phi$  E-W ROAD

MINNESOTA STATE  
PLANE COORDINATES  
SOUTH ZONE  
X = 1,559,688.10  
Y = 239,766.70

### BEARINGS OBSERVED WITH COMPASS

Statement of evidence relative to this corner location is on back of page

J.B.M. 8-30-88  
6-955

I hereby certify that this document and the data contained herein was prepared by me or under my direct supervision

Lowell R. Pomeroy Jr. 9-20-88  
SIGNATURE DATE

Registration No. 17005

- Land Surveyor,  Professional Engineer
- County Surveyor,  County Engineer

### OFFICE OF THE COUNTY RECORDER

County of Nobles

I hereby certify that this document was filed in the Co. Recorders office at 4:10 P.M. on the 21st day of September A.D., 1988

County Recorder James Howard

By \_\_\_\_\_, Deputy

DOCUMENT NO. 234938

North Quarter Corner Section 17, Township 102 North, Range 40 West

The DNR Bureau of Engineering contacted the following offices for survey information on this corner:

MN Secretary of State  
 Nobles County Recorder and Highway Engineer  
 Mn/DOT at Windom  
 Martin Land Surveying at Worthington  
 Rieke-Carroll-Muller

- 1868 The U.S. General Land Office notes in the Secretary of State's Office show the corner is a post, set in a mound with pits.
- No Date Surveyor's Record Book A-1, on page 58, obtained from the County Recorder's Office, contains a survey, surveyor not indicated. Survey shows a distance of 39.79 chains from this corner to the center of Section 8. No mention of a monument is made.
- 1901 Surveyor's Record Book A-2, on page 454, obtained from the County Recorder's Office, contains a survey by Milton S. Smith, County Surveyor. Survey shows a stone at this corner which measures 2680.5 ft. from adjoining section corners.
- 1935 A Surveyor's certificate of public highway corners, obtained from the County Highway Engineer, shows this corner was evidenced by a stone monument. Stone is in line with a fence south.
- 1959 A Field Book of ties and monuments of government corners, obtained from the County Highway Engineer, shows a stone at this corner. Placed an iron pin and took three reference ties.
- 1984 June 26, the DNR Bureau of Engineering hired a backhoe (Suby Backhoe of Worthington) to dig for evidence of this corner. Found an 8" by 8" by 16" stone down 14" at natural ground. Left the stone as found and placed a 1" square by 4" channel pipe on its south side. Stone measures:  
 2678.92 ft. from the northeast corner Section 18  
 2680.07 ft. from the northeast corner Section 17  
 on fence line north, on center line east-west road
- Analysis of the available information led the DNR Bureau of Engineering to conclude that the found stone marks the location of the corner.
- 1988 August, the DNR Bureau of Engineering revisited the corner and found the surface monument had been destroyed. Found the previously mentioned stone, and set a DNR Survey Marker over it.