

CERTIFICATE OF LOCATION OF GOVERNMENT CORNER

NORTH QUARTER Corner of Section 8, Township 102N, Range 40 W, 5th P.M.

STATE OF MINNESOTA, County of NOBLES

At the corner location shown on the sketch:

- On 6-26-84 found a PILE OF STONES (2-3"x4"x6") (2-3"x3"x5")
(1-4"x5"x6"), DOWN 22"
 left monument as found, lowered monument, removed monument (explain)
- On 6-26-84 placed a 1 1/4"x 1 1/4"x 20" PERFORATED STEEL TUBE WITH
ALUMINUM CAP STAMPED "DNR SURVEY MARKER", DOWN 2.2'

SKETCH OF REFERENCE TIES

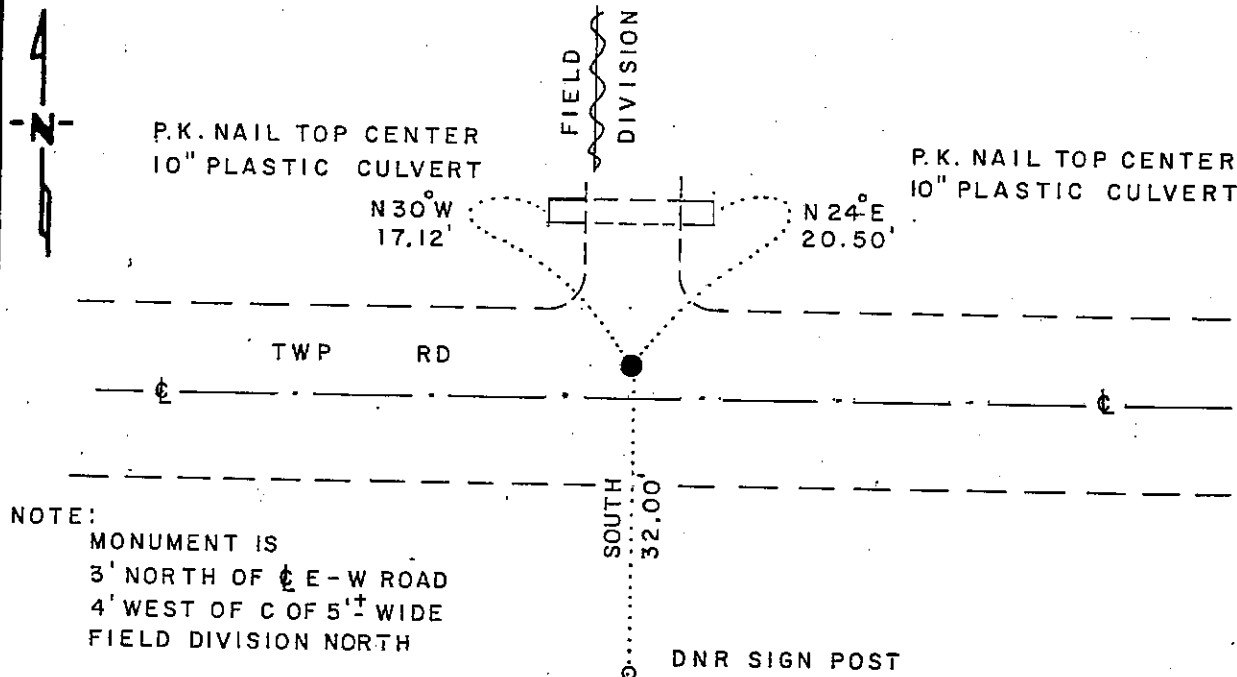

NOTE:
 MONUMENT IS
 3' NORTH OF ϕ E-W ROAD
 4' WEST OF C OF 5'± WIDE
 FIELD DIVISION NORTH
 TIES VERIFIED 8-9-88

MINNESOTA STATE
 PLANE COORDINATES
 SOUTH ZONE
 X = 1,559,795.78
 Y = 245,082.31

BEARINGS OBSERVED WITH COMPASS

Statement of evidence relative to this corner location is on back of page

J.B.M. 8-29-88
6-965

I hereby certify that this document and the data contained herein was prepared by me or under my direct supervision

Lowell B. Pommeroy 9-20-88
SIGNATURE DATE

Registration No. 17005

- Land Surveyor, Professional Engineer
- County Surveyor, County Engineer

OFFICE OF THE COUNTY RECORDER
County of Nobles

I hereby certify that this document was filed in the Co. Recorders office at 3:50 P. .M. on the 21st day of September A.D., 19 88

County Recorder Jared Howard
By _____, Deputy

DOCUMENT NO. 234935

North Quarter Corner Section 8, Township 102 North, Range 40 West

The DNR Bureau of Engineering contacted the following offices for survey information on this corner:

MN Secretary of State
Nobles County Recorder and Highway Engineer
Mn/DOT at Windom
Martin Land Surveying at Worthington
Rieke-Carroll-Muller

1868 The U.S. General Land Office notes in the Secretary of State's Office show the corner is a post, set in a mound with pits.

No Date Surveyor's Record Book A-1, on page 58, obtained from the County Recorder's Office, contains a survey, surveyor not indicated. Survey shows a distance of 40.80 chains from this corner to the northeast corner Section 8. The north line of Section 8 is shown to measure 81.61 chains, but no monumentation is shown.

1897 Surveyor's Record Book A-2, on page 286, obtained from the County Recorder's Office, contains a survey by Milton S. Smith, County Surveyor. Survey shows a symbol at this corner, but does not identify it. Corner measures:

2658 ft. from the northeast corner Section 8
1329 ft. from a stone at a sixteenth corner to the east

The north line of Section 8 is shown to measure 80.20 chains.

1901 Surveyor's Record Book A-2, on page 454, obtained from the County Recorder's Office, contains a survey by Milton S. Smith, County Surveyor. Survey shows a symbol at this corner, but does not identify it.

1980 February, field notes and worksheet, obtained from Martin Land Surveying, shows no monument was found at this corner. Occupation is shown as fence lines north and south, posts only wire down, and an east-west road. Established this corner at a lost position 2654.72 ft. from adjoining section corners and set a $\frac{1}{2}$ " rebar. Rebar is shown 29.8 ft. south and 1.9 ft. east of the intersection of above mentioned occupation.

1984 June 26, the DNR Bureau of Engineering hired a backhoe (Suby Backhoe of Worthington) to dig for evidence of this corner. Found a pile of stones, two 3" by 4" by 6", two 3" by 3" by 5" and a 4" by 5" by 6", down 22" at natural ground. Left the stones as found which are:

1 ft. west of fence line north, on edge of wooded area south
1 ft. north of center line east-west road
2649.32 ft. from the northeast corner Section 7
2658.07 ft. from the northeast corner Section 8

Analysis of the available information led the DNR Bureau of Engineering to conclude that the found stone pile marks the location of the corner.

1988 August, the DNR Bureau of Engineering revisited the corner and found the DNR Survey Marker previously set in good condition, now down 2.2 ft.

Tract D. S. Compared 7/24
Photo M. S.
Fee 2.00