

CERTIFICATE OF LOCATION OF GOVERNMENT CORNER

NORTHEAST Corner of Section 24, Township 102 N, Range 40 W, 5 P.M.

STATE OF MINNESOTA, County of NOBLES

At the corner location shown on the sketch:

On Dec. 3, 1991 found a bridge spike and 30d nail together, down 3 inches below
DATE
bituminous surface at intersection of roads.

left monument as found, lowered monument, removed monument (explain)

On _____ placed a _____
DATE

SECTION I

SKETCH OF REFERENCE TIES

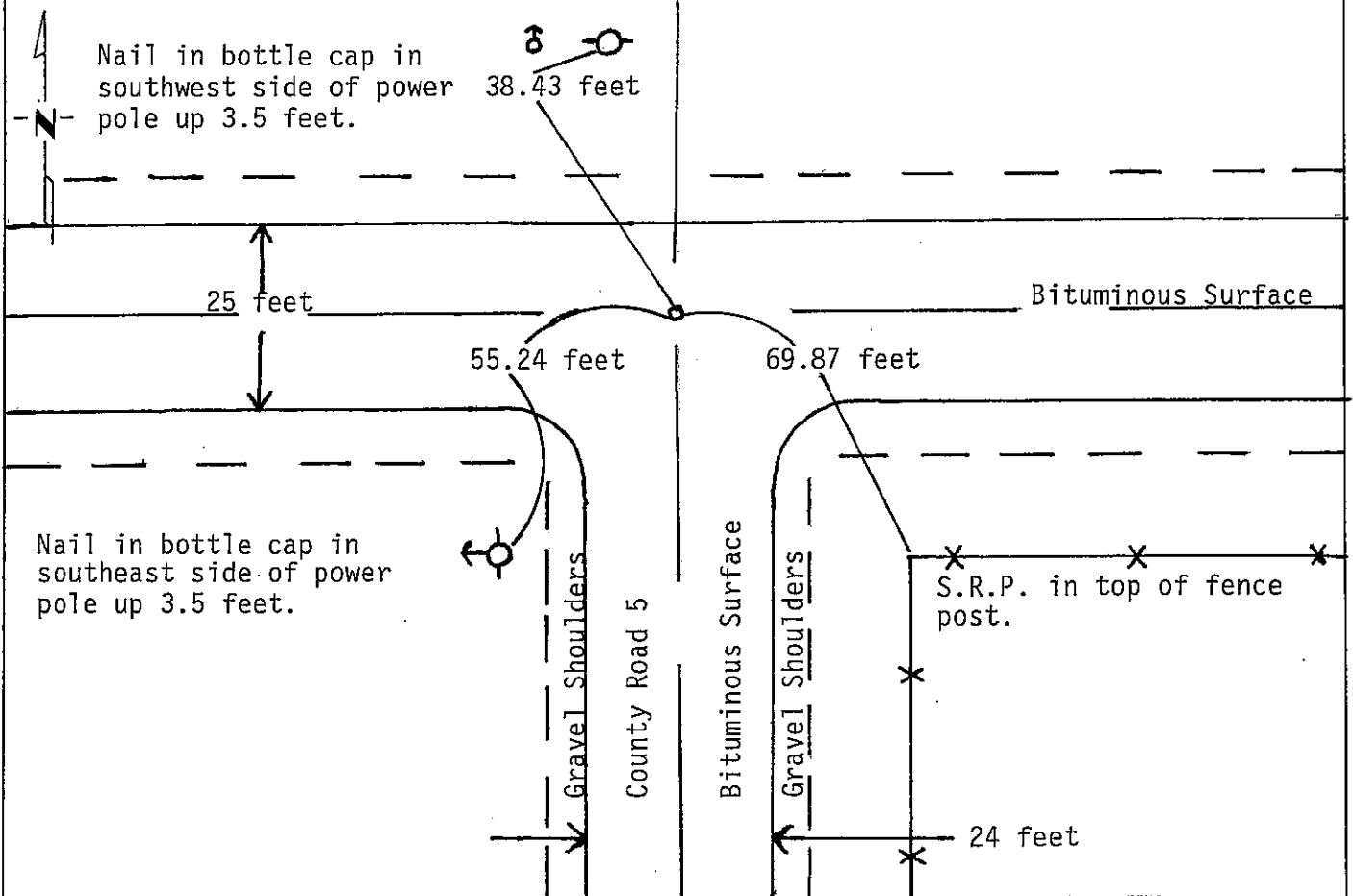

Statement of evidence relative to this corner location is on back of page.

I hereby certify that this document and the data contained herein was prepared by me or under my direct supervision.

Allan E. Schoon 10-1-92
SIGNATURE DATE

Registration No. 11858

- Land Surveyor, Professional Engineer
- County Surveyor, County Engineer

OFFICE OF THE COUNTY RECORDER

County of Nobles

I hereby certify that this document was filed in the Co. Recorders office at 2:50 P. M. on the 22nd day of October A.D., 19 92

County Recorder James Howard

By _____, Deputy

DOCUMENT NO. 249780

Statement of Evidence: Northeast Corner of Section 24, T102N, R40W, 5th P.M.

- 1867 The original Public Land Survey of the Range Line between Ranges 39W and 40W was run in 1867 by Deputy Surveyor Thomas B. Walker and his notes read, "point for corner 13, 24, 18 & 19 in pond. Wit cor 3.50 chs. south. Set post". (Notes state that charred stakes were used under all the mounds along this line between ranges 39 and 40.) (Measurement was 5287.9 feet to section corner west and 5438.4 feet section corner east.) The present measurement is 5316.426 feet.
- Apr. 13, 1892 Milton S. Smith, Nobles County Surveyor, made a survey of Section 24 for Geo. D. Dayton et al. He states "N.E. Sec. Cor. is in a Slough with a Wit. Cor. 231 ft south of true corner, the Government set Oak Post".
- 1894 Nobles County Highway Department Records indicate "set stone".
- 1896 & 1912 Nobles County Highway Department Records indicate "stone".
- Oct. 23, 1912 Wm. A. Saxon, Nobles County Surveyor, plat shows a stone at the corner.
- Oct. 29, 1914 Wm. A. Maxwell, Nobles County Surveyor, made a survey of the South-west quarter of Section 13 at the request of A.H. Parry and used the "old stone" monument at the Southeast corner. It is 2630 feet to "old stone" at east quarter and 5282 feet to northeast corner of Section 13.
- Sug. 22, 1918 Wm. A. Saxon, Nobles County Surveyor, No. 8 plat indicates "old stone".
- 1918 Nobles County Highway Department Records indicate "stone".
- June 19, 1934 Gebo, with the Minnesota Highway Department survey crew for S.P. 5306, notes state "assumed corner for S.W. cor. sec. 18-102-39." Dug 5 feet by 5 feet by 4 feet hole in effort to find monument.
- 1940 Nobles County Highway Department Records indicate "Stone, placed wood stake".
- 1959 Nobles County Highway Department Records indicate "Stake, placed iron pin".
- Apr. 8, 1960 M.A. Sater, a Minnesota Highway Department Survey Crew Chief, survey notes for S.P. 5380-01 read, "Found 5/8 inch diameter rod down 0.2 foot".
- 1964 Nobles County Highway Department Records indicate "iron pin".
- 1966 Nobles County Highway Department Records indicate "Iron pin set back after bituminous".
- Feb. 23, 1978 R. Foster, of the Minnesota Department of Transportation, found a "Br. spike" and a "30d nail" together flush near the center of a "T" road intersection.
- Dec. 3, 1991 John Brommer and survey crew, with the Minnesota Department of Transportation, found the bridge spike and updated the ties. The spike is 3 inches below the bituminous surface.

Statement of Evidence: Northeast Corner of Section 24, T102N, R40W, 5th P.M.

The in-place location of the bridge spike is compatible with the occupation lines within the section. An analysis of the Statement of Evidence and the field measurements indicate that the bridge spike is in a reasonable location for the corner. I accept the monument as the location of the land corner.

For additional information, including field measurements and photographs, contact the Minnesota Department of Transportation in Windom.

