

# CERTIFICATE OF LOCATION OF GOVERNMENT CORNER

NORTH QUARTER Corner of Section 13, Township 102 N, Range 41 W, 5th P.M.

STATE OF MINNESOTA, County of NOBLES

At the corner location shown on the sketch

- On 8-8-88 found a 1/2" IRON ROD, DOWN 0.5'  
DATE
- left monument as found,  lowered monument,  removed monument (explain)
- On 8-8-88 placed a 1 1/4" x 1 1/4" x 20" PERFORATED STEEL TUBE WITH  
DATE  
ALUMINUM CAP STAMPED "DNR SURVEY MARKER", DOWN 0.50', OVER IRON

### SKETCH OF REFERENCE TIES

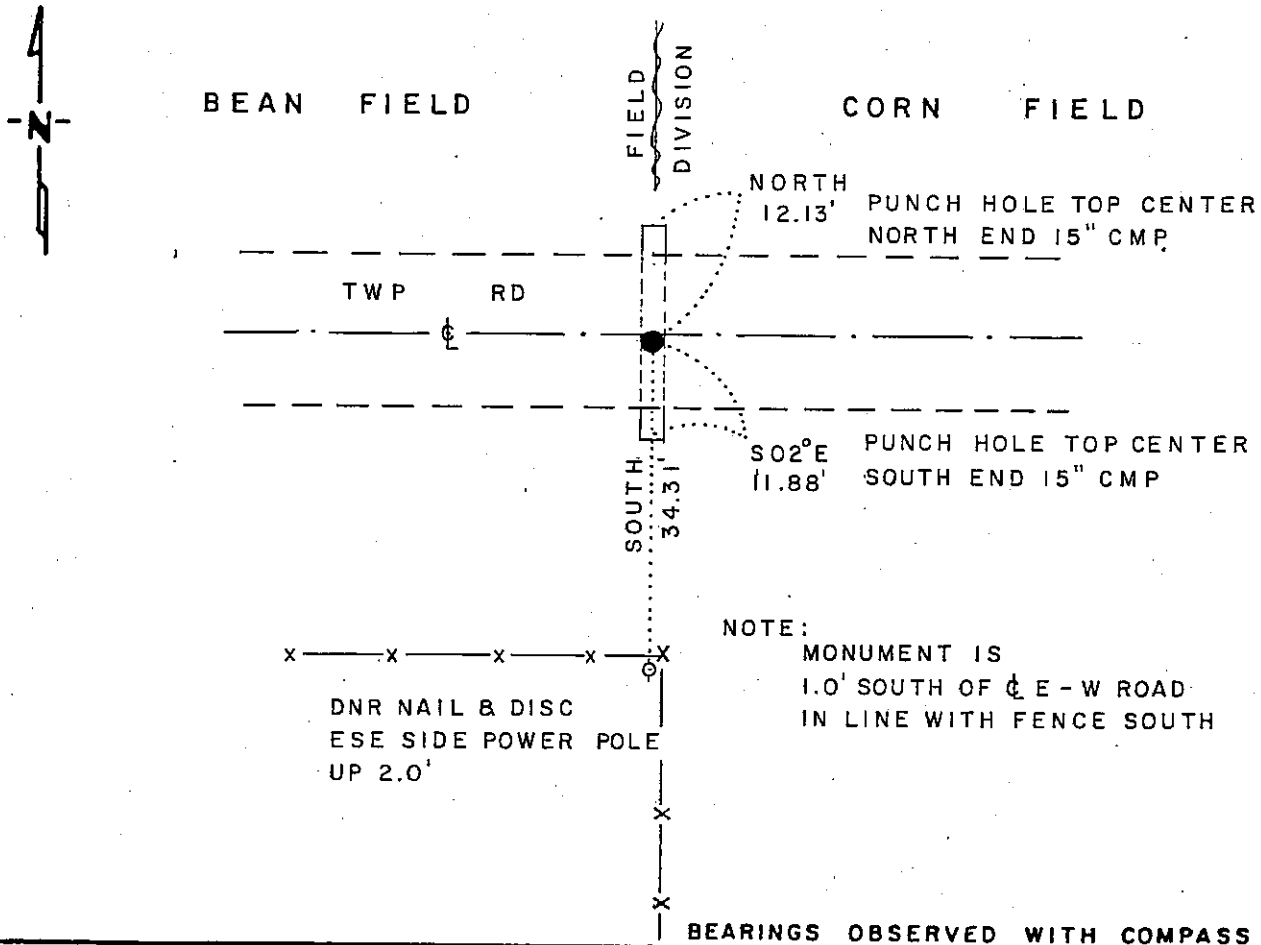

NOTE:  
MONUMENT IS  
1.0' SOUTH OF  $\phi$  E - W ROAD  
IN LINE WITH FENCE SOUTH

BEARINGS OBSERVED WITH COMPASS

Statement of evidence relative to this corner location is on back of page

J.B.M. 8-25-88  
6-965

I hereby certify that this document and the data contained herein was prepared by me or under my direct supervision.

Lowell R. Pommeroy 9-20-88  
SIGNATURE DATE

Registration No. 17005

- Land Surveyor,  Professional Engineer
- County Surveyor,  County Engineer

OFFICE OF THE COUNTY RECORDER  
County of Nobles

I hereby certify that this document was filed in the Co. Recorders office at 5:00 P. M. on the 21st day of September A.D., 19 88

County Recorder James Howard

By \_\_\_\_\_, Deputy

DOCUMENT NO. 234948

North Quarter Corner Section 13, Township 102 North, Range 41 West

The DNR Bureau of Engineering contacted the following offices for survey information on this corner:

MN Secretary of State  
Nobles County Recorder and Highway Engineer  
Mn/DOT at Windom  
Martin Land Surveying at Worthington  
Rieke-Carroll-Muller

1868 The U.S. General Land Office notes in the Secretary of State's Office show the corner is a post, set in a mound with pits.

No Date Surveyor's Record Book A-1, on page 42, obtained from the County Recorder's Office, contains a survey, surveyor not indicated. Survey shows this corner is marked by a post with mound and pits. Corner measures:

41.80 chains from the northeast corner Section 14  
39.66 chains from the northeast corner Section 13  
40.00 chains from the center of Section 12

1963 A Field Book of ties and monuments of government corners, obtained from the County Highway Engineer, shows an iron pin at this corner.

1972 June, the DNR Bureau of Engineering traversed to the area of the corner and found an iron pipe down 0.6 ft. Iron is on the center line of an east-west road in line with a fence south. Iron measures:

2661.07 ft. from the northeast corner Section 13  
2680.00 ft. from the northeast corner Section 14

1978 February, Mn/DOT found a 1" iron rod, down 0.1 ft., on center line east-west road approximately in line with a fence line south.

1978 August, the DNR Bureau of Engineering conducted a search for this corner and found a 1/2" iron rod with a cast iron cap down 0.1 ft. Iron is at the intersection of a east-west road and fence line south, over the west edge of a culvert. Iron measures:

2674.03 ft. from the northeast corner Section 14  
2660.98 ft. from the northeast corner Section 13

Analysis of the available information led the DNR Bureau of Engineering to conclude that the found iron rod marks the location of the corner. Using a proportion based on the old survey, the corner would be 63.55 east of the found iron. Since the found iron agrees with occupation, it marks the most likely position of the corner.

1988 August, the DNR Bureau of Engineering revisited the corner and found the iron rod as previously located, in good condition. Set a DNR Survey Marker over it.