

PREPARED BY: DGR ENGINEERING, 1302 S. UNION STREET, P.O. BOX 511, ROCK RAPIDS, IOWA 51246 (712) 472-2531

# UNITED STATES PUBLIC LAND SURVEY CORNER CERTIFICATE OF

Land Survey Monuments situated in Section 10, Township 102, Range 42  
of the Fifth Principal Meridian, NOBLES County, MINNESOTA.

### Monument Description and Remarks:

E1/4 CORNER-DUG WITH BACKHOE AN 8" DIA. HOLE; 3"± BELOW GRAVEL IN 6"-8" GRAVEL ROADS, NO MONUMENT FOUND.  
USED FENCES RUNNING N-S AND E-W ON R.O.W. LINE TO SET NEW MONUMENT BY PRACTICAL LOCATION  
SET 1/2" DIA. X 30" REBAR 6" BELOW GRAVEL WITH YELLOW SURVEYOR'S I.D. CAP NO. 17518

### PLAN - VIEW

COORD'S SHOWN  
ARE MINNESOTA SPC,  
SOUTH ZONE, US FOOT  
NAD 83 (2011)

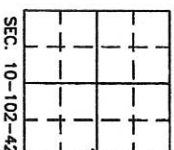

SEC. 10-102-42

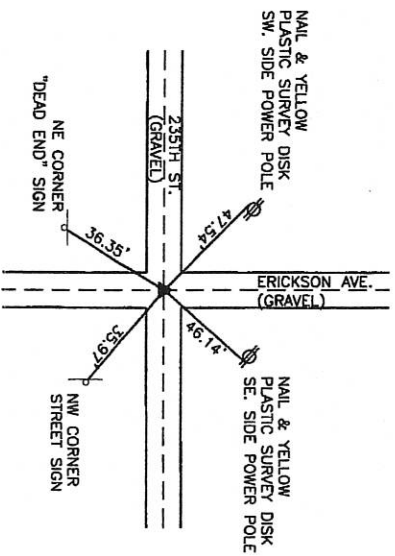

E.1/4 SEC. 10-102-42  
571446.41 NORTH  
2133965.91 EAST

I hereby certify that this land surveying document was prepared and the related survey work was performed by me or under my direct personal supervision and that I am a duly licensed Land Surveyor under the laws of the State of Minnesota.

Signature: Kevin D. Jongsorius  
Name Typed or Printed: KEVIN D. JONGSORIUS

Date: May 17, 2014 LIC. No. 17518



SEAL

Corners	Section	Twp	Range
E.1/4 COR.	10	102	42