

CERTIFICATE OF LOCATION OF GOVERNMENT CORNER

EAST QUARTER Corner of Section 24, Township 103N, Range 39W, 5 P.M.

STATE OF MINNESOTA, County of NOBLES

At the corner location shown on the sketch:

- On Oct. 6, 1989 found a 12 inch by 10 inch by 20 inch stone set on end with
DATE
definite high point 18 inches below surface (See statement of evidence).
 left monument as found, lowered monument, removed monument (explain)
- On Oct. 9, 1989 placed a Minnesota Department of Transportation cast iron
DATE
monument 0.8 feet below surface

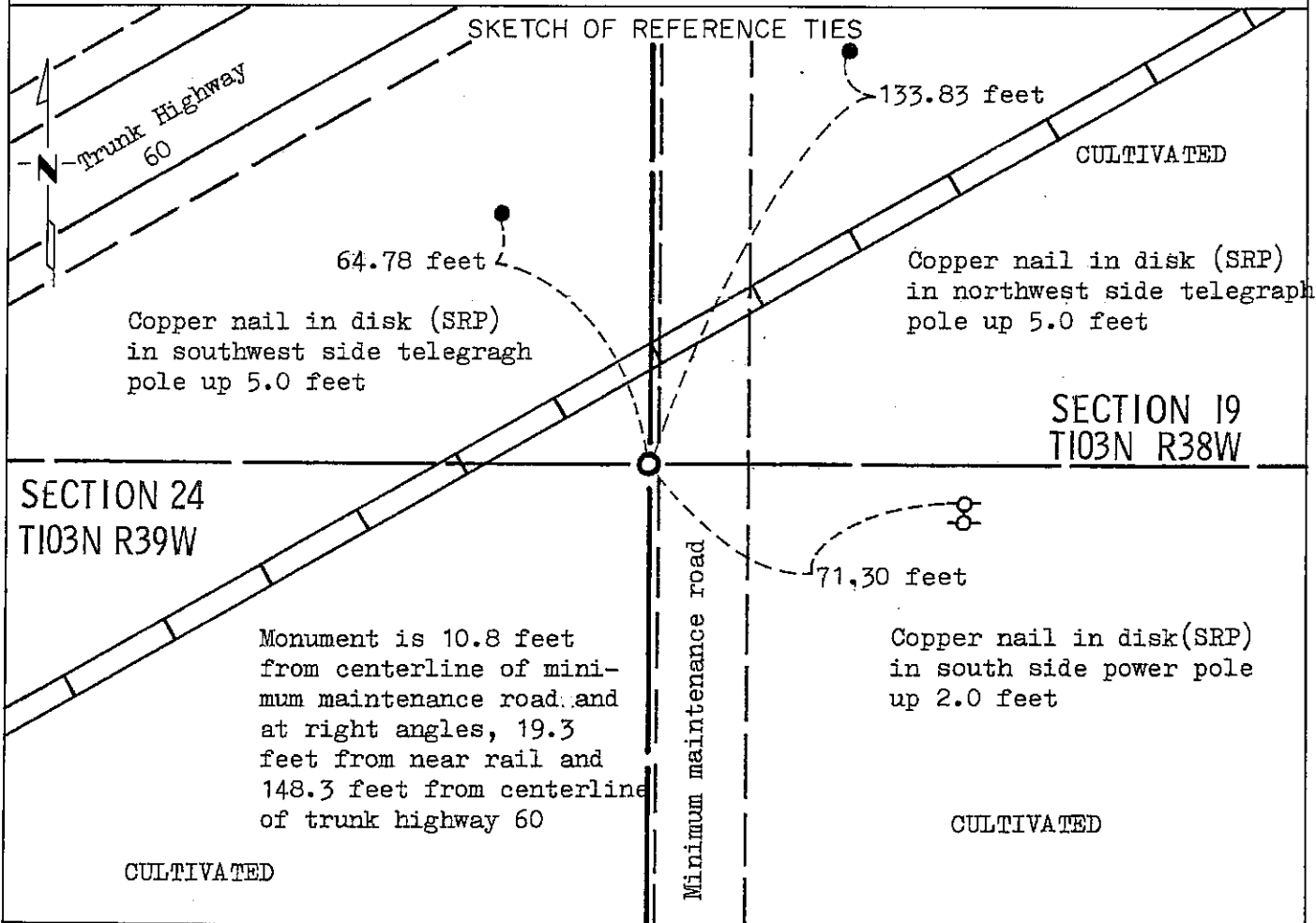

Statement of evidence relative to this corner location is on back of page.

I hereby certify that this document and the data contained herein was prepared by me or under my direct supervision.

Allan E. Schorn 3-14-91
SIGNATURE DATE

Registration No. 11858

- Land Surveyor, Professional Engineer
- County Surveyor, County Engineer

OFFICE OF THE COUNTY RECORDER

County of Nobles

I hereby certify that this document was filed in the Co. Recorders office at 8:45 A.M. on the 11th day of September A.D., 19 91

County Recorder Jane Howard

By _____, Deputy

DOCUMENT NO. 245431

Statement of Evidence: East Quarter Corner Section 24 T103N R39W 5th P.M.

- 1857 The original Public Land Survey of the Range line between Ranges 38W and 39W was run by Deputy Surveyor James A. Langton, and his notes read: "Set qr. sec. post deposited charcoal & pits as per instructions".
- Nov. 2, 1925 A survey plat by John Spolman, Nobles County Surveyor, reads: "Set stone".
- 1925 Nobles County Highway Department records show a stone in 1925.
- Apr. 13, 1978 A survey of Section 19-103-38, by Sioux Engineering, Inc. of Windom, Minnesota, indicates a 5/8 inch by 36 inch iron stake placed on line and midway between the section corners to the north and to the south.
- Oct. 6, 1989 A Minnesota Department of Transportation field survey crew, consisting of R. Busse, D. Ernst and T. Makovsky, searched for the corner using a tractor mounted backhoe. During the course of their excavation, they found a stone with no visible markings surrounded by railroad spikes about 2 feet southwest of a 5/8 inch diameter by 22½ inch long rebar. The rebar was bent over and the exact location was lost while digging with the backhoe, so it could not be replaced. The stone and railroad spikes were lowered to accommodate placement of a Minnesota Department of Transportation Public Land Survey Monument 0.8 foot below the surface and directly over the point on the stone.

The stone, set by John Spolman, in his survey of November 2, 1925, is in a reasonable location. An analysis of survey records and occupation lines of long standing indicate that the in place stone is at the corner.

For additional information, including measurements and photographs, contact the Minnesota Department of Transportation in Windom, Minnesota.

Tract 19-103-38 Compared du
 Photo 19-103-38
 Fee 710