

CERTIFICATE OF LOCATION OF GOVERNMENT CORNER

NORTHEAST Corner of Section 12, Township 103N, Range 40W, 5 P.M.

STATE OF MINNESOTA, County of NOBLES

At the corner location shown on the sketch:

On Nov. 6, 1980 found a $\frac{1}{4}$ inch iron pin down 0.3 foot, 4 inch by 7 inch by 11 inch stone down 2.0 foot and 6 inch by 4 inch by 8 inch stone down 2.0 foot
DATE
 left monument as found, lowered monument, removed monument (explain)

On _____ placed a _____
DATE

SKETCH OF REFERENCE TIES

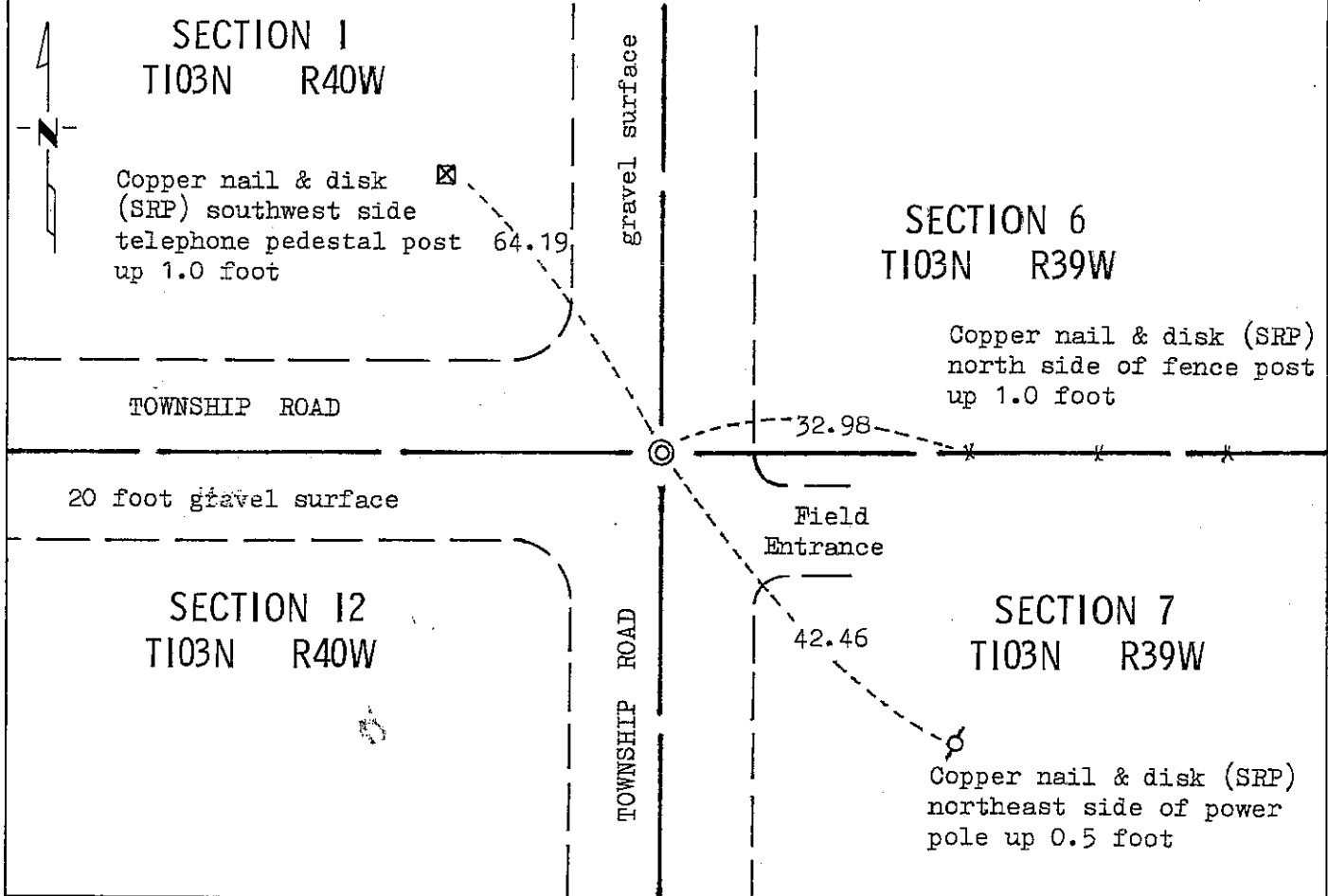

Statement of evidence relative to this corner location is on back of page.

I hereby certify that this document and the data contained herein was prepared by me or under my direct supervision.

Allan E. Schorn SIGNATURE 10-15-92 DATE

Registration No. 11858

- Land Surveyor, Professional Engineer
- County Surveyor, County Engineer

OFFICE OF THE COUNTY RECORDER

County of Nobles

I hereby certify that this document was filed in the Co. Recorders office at 3:10 P. M. on the 22nd day of October A.D., 1992

County Recorder Jay Howard

By _____, Deputy

DOCUMENT NO. 249785

Statement of Evidence: Northeast 12, T103N, R40W, 5th P.M.

- July 5, 1867 T. B. Walker - Original Public Land Survey notes read, "Cor. Secs. 1, 12, 6 & 7 for which post in mound & c. Slightly rolling, soil good."
- August 28, 1891 M. S. Smith, County Surveyor, made a survey in Section 1, notes indicate he found original stake in mound at Northeast Corner Section 12. Distance between Northeast Corner Section 1 to Northeast Corner section 12 is 5299.14 feet.
- April 18, 1892 M. S. Smith, County Surveyor, notes indicate he located the original stake of Northeast Corner Section 12 and set new post. Measurement to North Quarter Corner Section 7 is 2966.4 feet, located West Quarter Corner Section 7 as "stones". Interviewed area residents, all claimed it to be original corner, but Smith says it is west about 1 rod to far. Measurement from center of creek south to Northeast Corner Section 12 is 1950 feet.
- September 7, 1893 M. S. Smith, County Surveyor, made a survey in Section 6-103-39, notes indicate he found original stake in mound at Northeast corner Section 12 and set stones along west side of Section 6 every 1324.8 feet, also found original stake in mound and pits at North Quarter Corner Section 7-103-39 distance 3010.4 feet east to stone.
- August 22, 1899 M. S. Smith, County Surveyor, made a survey in Section 1. Symbol on drawing indicates there is a monument at Southeast Corner.
- October 14, 1903 Unknown - Notes of a survey in Section 12 indicate there may be a stone at Northeast Corner Section 12. Distances 2611.0 feet to East Quarter Corner Section 12 and 5227.5 feet to Northeast corner Section 13.
- November 6, 1980 Minnesota Department of Transportation field survey crew using a tractor backhoe found a $\frac{1}{2}$ inch iron pin 0.3 foot below gravel surface, a 4 inch by 7 inch by 11 inch stone along east side of iron pin, and a 6 inch by 4 inch by 8 inch stone along west side of iron pin, both stones 2.0 feet below gravel surface.
- An analysis of evidence indicates the original stake in mound was visible in 1891, new post set in 1892, stones set along the west side of section 6 in 1893, section corner monument was identified and used in 1899 and 1903 for land surveys. The two small stones with a $\frac{1}{2}$ inch iron stake between presently mark the location of land corner.
- For additional information, including field measurements and photographs, contact the Minnesota Department of Transportation in Windom.
- December 2, 1991 A Minnesota Department of Transportation survey crew using a magnetic locator got a reading from the iron pin and verified the reference ties to be in place.