

CERTIFICATE OF LOCATION OF GOVERNMENT CORNER

South 1/4 Corner of Section 20, Township 103N, Range 40W, 5th P.M.

STATE OF MINNESOTA, County of Nobles

At the corner location shown on the sketch

On 9/16/05 found a mag nail over iron stake on road & in line with fence north.

left monument as found lowered monument, removed monument (explain)

On _____ placed a _____

SKETCH OF REFERENCE TIES

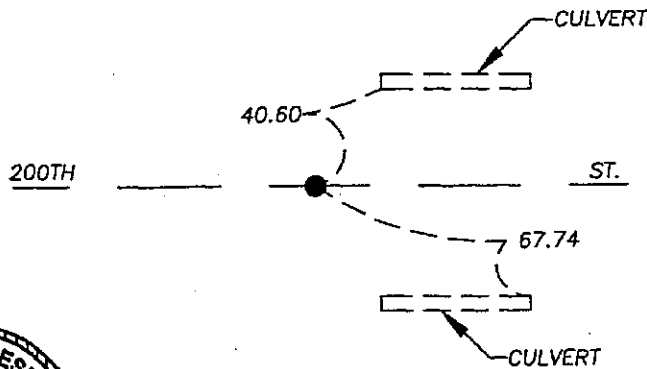
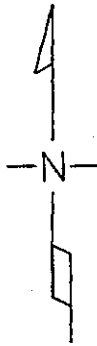

NAD 83 (1996)
US STATE PLANE 1983
MN SOUTH
589094.45N
2184833.83E

Statement of evidence relative to this corner location is on page 2.

I hereby certify that this document and the data contained herein was prepared by me or under my direct supervision.

Dennis Ray Esplan 10/11/05
SIGNATURE DATE

MN. LICENSE NO. 43803

Land Surveyor, Professional Engineer

County Surveyor, County Engineer

OFFICE OF THE COUNTY RECORDER

I hereby certify that this document was filed in the Co. Recorder's Office at _____ on the

_____ day of _____

County Recorder _____

By _____, Deputy

DOCUMENT NO. _____

DOCUMENT NUMBER A 306916

Statement of Evidence

1868 Original Township Subdivision was surveyed by Jewett H. Howe.

1918 Nobles Co. Hwy. Dept. records indicate a stone was set.

1953 Nobles Co. Hwy. Dept. records indicate a stone was found and wood stake was set.

1968 Nobles Co. Hwy. Dept. records indicate that a stake was found and an iron pin was set.

1980 & 1992 Nobles Co. Hwy. Dept. records indicate that an iron pin was found.

2003 Nobles Co. Hwy. Dept. records indicate that a P.K. nail was set after overlay.

2005 Gerald Vickerman PLS and Jeremy Lund, with Zieske Land Surveying, found a mag nail on road centerline and in line with fence north.

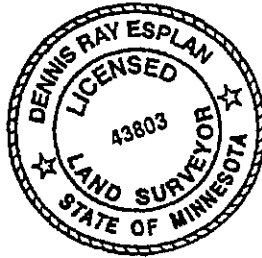

DOCUMENT NUMBER A 306916

Certified, Filed and or Recorded on
NOV. 10, 2005 AT 10:00:00AM

Lynn M. Wilson aw

TRACKED _____ COMPARED _____
PHOTO *JD*
FEE _____

NOBLES COUNTY RECORDER
LYNN M. WILSON
507-372-8216