

CERTIFICATE OF LOCATION OF GOVERNMENT CORNER

Southwest Corner of Section 17, Township 103N, Range 40W, 5th P.M.

STATE OF MINNESOTA, County of Nobles

At the corner location shown on the sketch

On 9/13/05 found a Iron Stake on a road @ north & south and 3' south of @ east and west.

left monument as found lowered monument, removed monument (explain)

On _____ placed a _____

SKETCH OF REFERENCE TIES

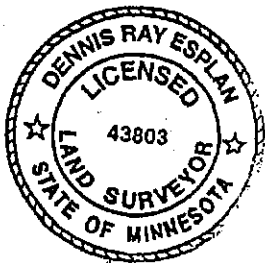
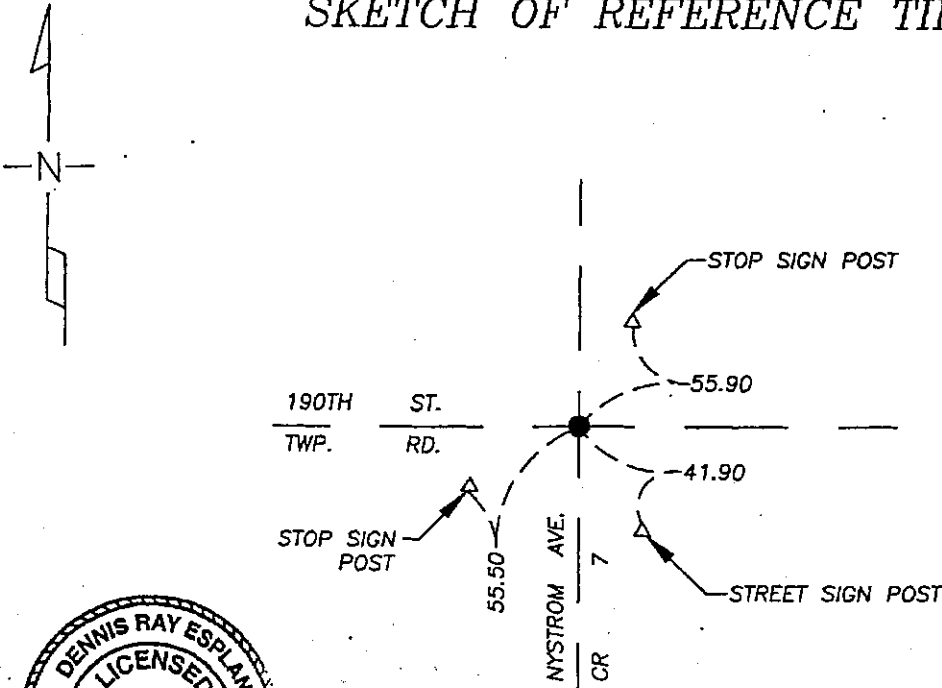

NAD 83 (1996)
US STATE PLANE 1983
MN SOUTH
594456.06N
2182335.46E

Statement of evidence relative to this corner location is on page 2.

I hereby certify that this document and the data contained herein was prepared by me or under my direct supervision.

Dennis Ray Esplan SIGNATURE 10/11/05 DATE

MN. LICENSE NO. 43803

- Land Surveyor, Professional Engineer
 County Surveyor, County Engineer

OFFICE OF THE COUNTY RECORDER

I hereby certify that this document was filed in the Co. Recorder's Office at _____ on the

_____ day of _____

County Recorder _____

By _____, Deputy

DOCUMENT NO. _____

DOCUMENT NUMBER A 306907

Statement of Evidence

1868 Original Township Subdivision was surveyed by Jewett H. Howe.

1914 Nobles Co. Hwy. Dept. records indicate a stone was found.

1937 & 1963 Nobles Co. Hwy. Dept. records indicate a stone was found.

2000 Nobles Co. Hwy. Dept. records indicate an iron pin was found.

2005 Gerald Vickerman PLS and Jeremy Lund, with Zieske Land Surveying, found an iron stake on road centerline north & south and 3' south of road centerline east and west.



DOCUMENT NUMBER A 306907

Certified, Filed and or Recorded on
NOV. 10, 2005 AT 09:15:00AM

Lynn M. Wilson _{aw}

TRACED _____ COMPARED _____
PHOTO SS
FEE _____

NOBLES COUNTY RECORDER
LYNN M. WILSON
507-372-8216