

CERTIFICATE OF LOCATION OF GOVERNMENT CORNER

West 1/4 Corner of Section 19, Township 103, Range 40, 5th P.M.

STATE OF MINNESOTA, County of Nobles

At the corner location shown on the sketch

- On 9/09/05 found a 20" Stone 42" deep.
- left monument as found lowered monument, removed monument (explain)
- On 9/09/05 placed a 1" Iron Pipe with red survey cap #43803 over top of stone.

SKETCH OF REFERENCE TIES

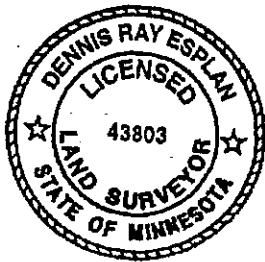
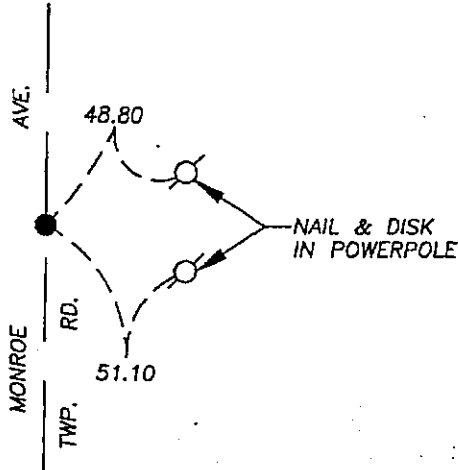
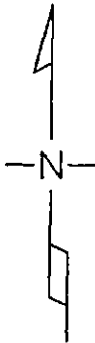

NAD 83 (1996)
US STATE PLANE 1983
MN SOUTH
591820.45N
2182252.21E

Statement of evidence relative to this corner location is on page 2.

I hereby certify that this document and the data contained herein was prepared by me or under my direct supervision.

Dennis Ray Esplan 10/11/05
SIGNATURE DATE

MN. LICENSE NO. 43803

- Land Surveyor, Professional Engineer
- County Surveyor, County Engineer

OFFICE OF THE COUNTY RECORDER

I hereby certify that this document was filed in the Co. Recorder's Office at _____ on the

_____ day of _____

County Recorder _____
By _____, Deputy

DOCUMENT NO. _____

DOCUMENT NUMBER A 306910

Statement of Evidence

1867 Original Township lines were surveyed by T.B. Walker.

Nobles Co. Hwy. Dept. had no records of anything at this corner.

2005 Gerald Vickerman PLS and Jeremy Lund, with Zieske Land Surveying, excavated with backhoe and found a 20" stone 42" deep. Crew placed 1" iron pipe with red survey cap #43803 over top of stone.



01/19/2005

DOCUMENT NUMBER A 306910

Certified, Filed and or Recorded on
NOV. 10, 2005 AT 09:30:00AM

Lynn M. Wilson _{ew}

TRACKED COMPARED
PHOTO
FEE

NOBLES COUNTY RECORDER
LYNN M. WILSON
507-372-8216