

CERTIFICATE OF LOCATION OF GOVERNMENT CORNER

South 1/4 Corner of Section 13, Township 103N, Range 41W, 5th P.M.
STATE OF MINNESOTA, County of Nobles

At the corner location shown on the sketch

☒ On 9/16/05 found a 1/2 Iron pipe 10" deep, on road & in line with fence
north and south.

☒ left monument as found ☐ lowered monument, ☐ removed monument (explain)

☐ On _____ placed a _____

SKETCH OF REFERENCE TIES

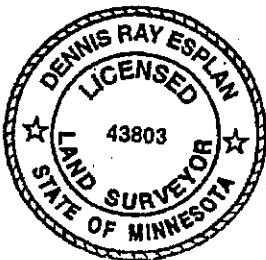
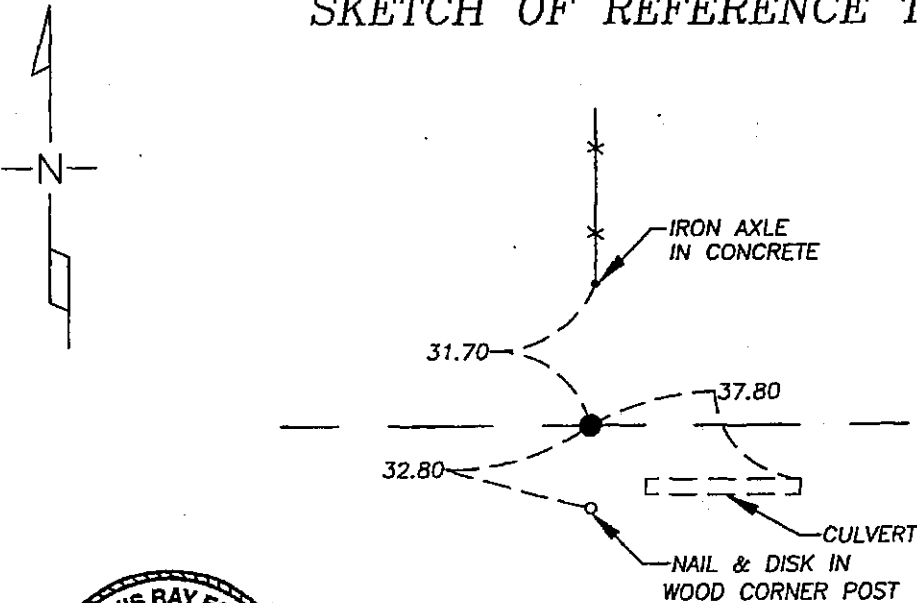

NAD 83 (1996)
US STATE PLANE 1983
MN SOUTH
S 294562.71N
E 2174393.73E

Statement of evidence relative to this corner location is on page 2.

I hereby certify that this document and the data contained herein was prepared by me or under my direct supervision.

Dennis Ray Esplan 10/11/05
SIGNATURE DATE

MN. LICENSE NO. 43803

☒ Land Surveyor, ☐ Professional Engineer

☐ County Surveyor, ☐ County Engineer

OFFICE OF THE COUNTY RECORDER

I hereby certify that this document was filed in the Co. Recorder's Office at _____ on the

_____ day of _____

County Recorder _____

By _____, Deputy

DOCUMENT NO. _____

Statement of Evidence

1868 Original Township Subdivision was surveyed by Jewett H. Howe.

1966 Nobles Co. Hwy. Dept. records indicate 3/4" iron rod was found, placed 18" X 1/2" iron pipe.

2005 Gerald Vickerman PLS and Jeremy Lund, with Zieske Land Surveying, found 1/2" iron pipe as per county records.

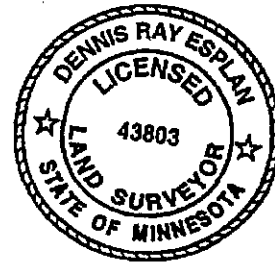

DOCUMENT NUMBER A 306930

Certified, Filed and or Recorded on
NOV. 10, 2005 AT 11:10:00AM

Lynn M. Wilson 80

TRACKED SS
PHOTO SS
FEE

COMPARED

NOBLES COUNTY RECORDER
LYNN M. WILSON
507-372-8216