

163

5/4
Sec 15
104
41

COPY

CERTIFICATE OF LOCATION OF GOVERNMENT CORNER

NORTH QUARTER Corner of Section 22, Township 104N, Range 41W

5th Principal Meridian, State of Minnesota, County of Nobles.

At the corner location shown on the sketch:

On 11/10/2017 found a PK NAIL ON CENTERLINE AND OCCUPATION LINES TO THE SOUTH
DATE

left monument as found lowered monument removed monument (explain)

On _____ placed a _____
DATE

SKETCH OF REFERENCE TIES

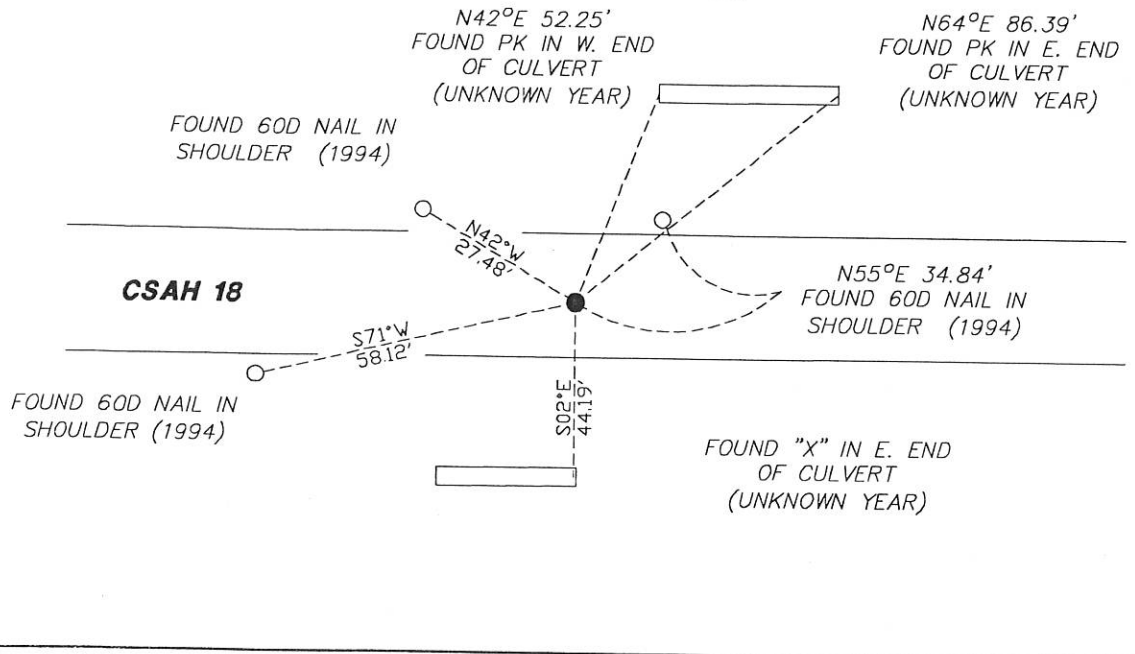

Statement of evidence for this corner location is on back of this page.

I hereby certify that this document was researched and prepared by me or under my direct supervision and that I am a licensed Land Surveyor under the laws of the State of Minnesota.

Signature [Handwritten Signature]

Date 1/29/18 License No. 49563

Title:

- Land Surveyor Professional Engineer
- County Surveyor County Engineer

DOCUMENT NUMBER A 357584
Certified, Filed and or Recorded on
March 08, 2018 8:10 AM

[Handwritten Signature: Lynn M. Wilson]

NOBLES COUNTY RECORDER
LYNN M. WILSON
507-295-5268

Statement of Evidence:

N-15

North Quarter Corner of Section 22, Township 104 North, Range 41 West, 5th Principal Meridian, Nobles County, Minnesota.

1868-Deputy Surveyor set a post in mound with pits.

1903 - County Surveyor in Book 22, Page 135 shows a distance of 2651.5 to the NE 22 and (presumably) 2651.4 to the NW 22.

1982 - Nobles County Highway Department "Corner Ties Book" notes a found 2x2 hub found and an iron pin placed to mark the corner location.

1983 - CSAH 18 highway plans show the corner location at station 184+29.69.

1993 - Nobles County Highway Department "Corner Ties Book" notes an iron pin found.

1994 - Nobles County Highway Department "Corner Ties Book" notes a 1 3/4" PK nail set after an overlay. The following ties were made:

60d nail in shoulder	NE	34.84'
60d nail in shoulder	NW	27.48'
60d nail in shoulder	SW	58.12'

2017 - Westwood field crews recover a PK nail and ties from 1994. Other ties of unknown origin were also recovered. Ties were found or set as shown on the front of this certificate.

Analysis of the recovered data, field evidence and survey measurements, indicates that the monument found is the correct perpetuation of this corner. For additional information concerning this corner please contact Westwood Professional Services.