

SW sec 10 104 41

COPY

Index J-13

CERTIFICATE OF LOCATION OF GOVERNMENT CORNER

NORTHEAST Corner of Section 16, Township 104N, Range 41W

5th Principal Meridian, State of Minnesota, County of Nobles.

At the corner location shown on the sketch:

☒ On 11/29/2017 found a 5/8" REBAR IN THE CENTERLINE INTERSECTION
DATE

☒ left monument as found ☐ lowered monument ☐ removed monument (explain)

☐ On _____ placed a _____
DATE

SKETCH OF REFERENCE TIES

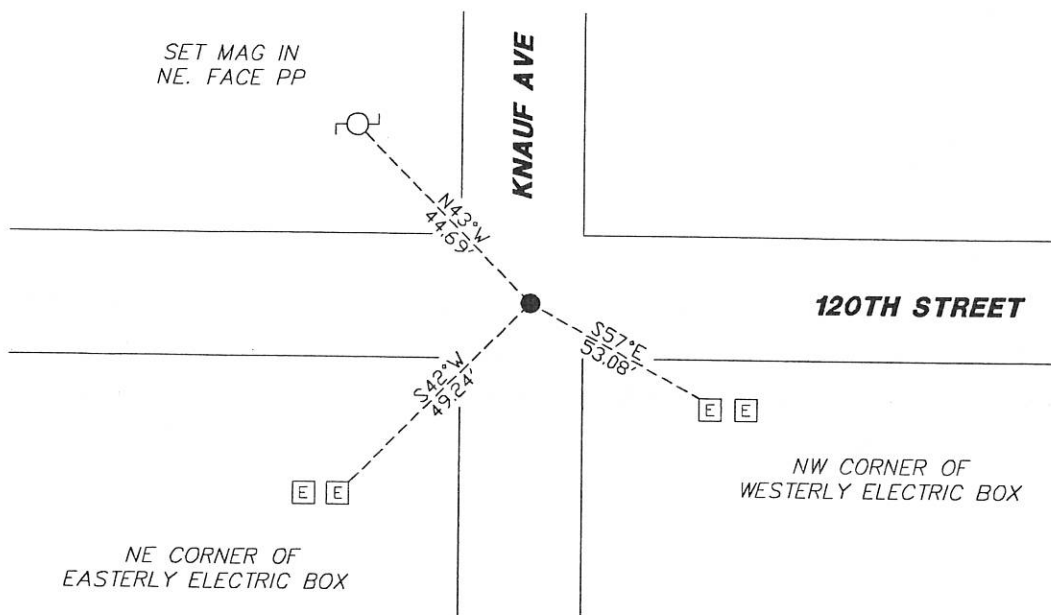

N.T.S.

Statement of evidence for this corner location is on back of this page.

I hereby certify that this document was researched and prepared by me or under my direct supervision and that I am a licensed Land Surveyor under the laws of the State of Minnesota.

Signature L. Wilson

Date 1/29/18 License No. 49563

Title:

☒ Land Surveyor ☐ Professional Engineer
☐ County Surveyor ☐ County Engineer

DOCUMENT NUMBER A 357572
Certified, Filed and or Recorded on
March 07, 2018 3:05 PM

Lynn Wilson

NOBLES COUNTY RECORDER
LYNN M. WILSON
507-295-5268

Pages: 2

Statement of Evidence:

J-13

Northeast Corner of Section 16, Township 104 North, Range 41 West, 5th Principal Meridian, Nobles County, Minnesota.

1868-Deputy Surveyor set a post in mound with pits.

1903 - County Surveyor in Book 22, Page 135, gives a distance of 2650.4 to the N1/4 of 15 and a distance of 2625 to the W1/4 of 15.

1937 - Nobles County Highway Department "Corner Ties Book" notes a stone marking the corner location.

2017-On November 29th, Westwood Professional Services recovered a 5/8" rebar down 0.3' on centerline of north/south/east/west roadways. Westwood measures 2643.43 to the N1/4 of 15 which agrees within reason to the 1903 measurement. Ties were found or set as shown on the front of this certificate.

Analysis of the recovered data, field evidence and survey measurements, indicates that the monument found is the correct perpetuation of this corner. For additional information concerning this corner please contact Westwood Professional Services.

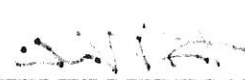
8/1/2011