

3 W 1/4
Sec 18

104 41

COPY

Index L-25

CERTIFICATE OF LOCATION OF GOVERNMENT CORNER

EAST QUARTER _____ Corner of Section 13, Township 104N, Range 42W

5th Principal Meridian, State of Minnesota, County of Nobles.

At the corner location shown on the sketch:

On 11/10/2017 found a 5/8" REBAR, DOWN 1.2' +/- 17 FEET EAST OF CENTERLINE.
DATE

left monument as found lowered monument removed monument (explain)

On _____ placed a _____
DATE

SKETCH OF REFERENCE TIES

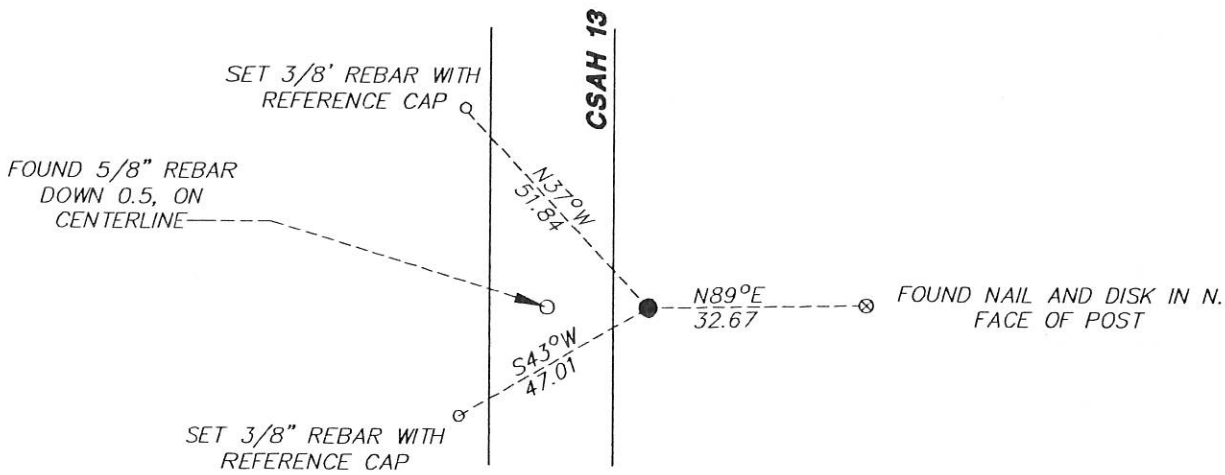

N.T.S.

Statement of evidence for this corner location is on back of this page.

I hereby certify that this document was researched and prepared by me or under my direct supervision and that I am a licensed Land Surveyor under the laws of the State of Minnesota.

Signature L. Wilson

Date 2/7/18 License No. 49563

Title:

- Land Surveyor Professional Engineer
- County Surveyor County Engineer

DOCUMENT NUMBER A 357485
Certified, Filed and or Recorded on
March 05, 2018 11:30 AM

Lynn Wilson

NOBLES COUNTY RECORDER
LYNN M. WILSON
507-295-5268

Pages: 2

Statement of Evidence:

L-25

East Quarter Corner of Section 13, Township 104 North, Range 42 West, 5th Principal Meridian, Nobles County, Minnesota.

1868-Deputy Surveyor set a post in mound with pits

1950-Nobles County Highway Department "Corner Ties Book" calls for a iron pin as the corner position.

1951-C.S.A.H. No. 13 highway plans shows an iron pin at station 185+36.95 for the centerline pin and an iron pin 17.0 ft. east of station 185+36.95 for the 1/4 corner.

1960-Nobles County Highway Department "Corner Ties Book" calls for an iron pin as the corner position.

1980-Nobles County Highway Department "Corner Ties Book" calls for an iron pin as the corner position.

Ties:

N&D IN FE POST N.E. 39.46'

N&D IN COR FE POST E. 33.17'

N&D IN PP S.E. 97.23'

(TRUE CORNER IS 3.4' EAST OF MAT)

2017-On November 10th, Westwood Professional Services found a No. 5 rebar on N/S centerline and online with occupation to the west, down 0.5 ft. Also found a No. 5 rebar +/-17 ft east of the one found at centerline, down 1.2 ft. Found 1 1980 Nobles County Highway Department tie which fits the easterly monument. Both monuments match stationing shown on C.S.A.H. No. 13 highway plans. Accepting the east No. 5 rebar as the correct position of the corner.

Analysis of the recovered data, field evidence and survey measurements, indicates that the monument found is the correct perpetuation of this corner. For additional information concerning this corner please contact Westwood Professional Services.

3/1/15