

RS
W1/4
sec 28
104 41

COPY

Index T-9

CERTIFICATE OF LOCATION OF GOVERNMENT CORNER

EAST QUARTER Corner of Section 29, Township 104N, Range 41W

5th Principal Meridian, State of Minnesota, County of Nobles.

At the corner location shown on the sketch:

☐ On _____ found _____
DATE

☐ left monument as found ☐ lowered monument ☐ removed monument (explain)

☒ On 11/09/2017 placed a 5/8" REBAR CAPPED 49563 EQUIDISTANT BETWEEN SECTION CORNERS
DATE AND ON CENTERLINE

SKETCH OF REFERENCE TIES

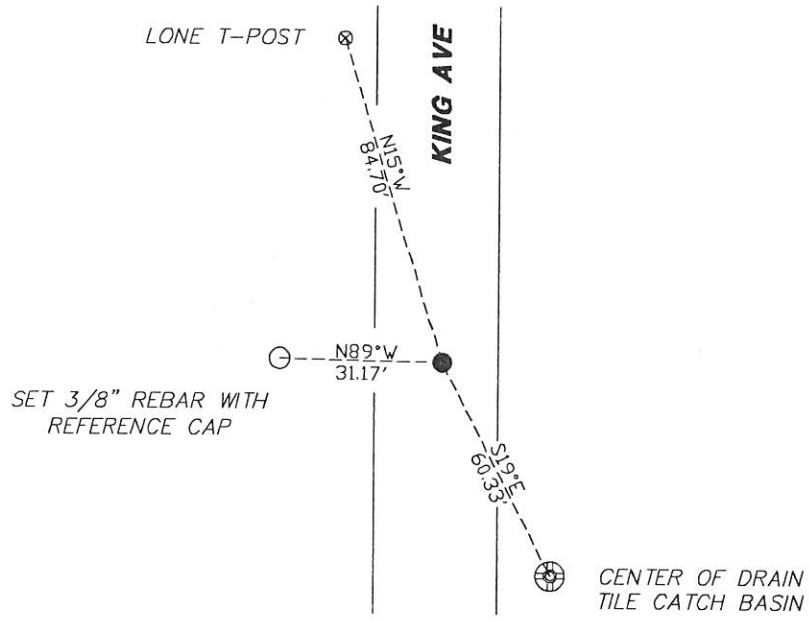

Statement of evidence for this corner location is on back of this page.

I hereby certify that this document was researched and prepared by me or under my direct supervision and that I am a licensed Land Surveyor under the laws of the State of Minnesota.

Signature LMW

Date 1/29/18 License No. 49563

Title:

☒ Land Surveyor ☐ Professional Engineer
☐ County Surveyor ☐ County Engineer

DOCUMENT NUMBER A 357591

Certified, Filed and or Recorded on

March 08, 2018 8:45 AM

Lynn M. Wilson

NOBLES COUNTY RECORDER

LYNN M. WILSON

507-295-5268

Pages: 2

Statement of Evidence:

T-9

East Quarter Corner of Section 29, Township 104 North, Range 41 West, 5th Principal Meridian, Nobles County, Minnesota.

1868-Deputy Surveyor Richard N. L. Jeorlt, set a post in mound with pits for the section corner.

1900-Nobles County Highway Department "Corner Ties Book" calls for a stone at the corner location.

1900-Surveyor's Record Book A-2, page 382, prepared by County Surveyor M.S. Smith shows a stone at the corner location and states "found old Cottonwood".

2017-On November 9th, Westwood Professional Services searched at N/S centerline and online with berm running east; found nothing. Set a 5/8" rebar capped 49563 equidistant between the NE and SE corners of Section 29 T.104 R.41 and slid west to centerline. Position lands +/-3.5 ft. south of westerly berm extension. Ties were set as shown on the front of this certificate.

Analysis of the recovered data, field evidence and survey measurements, indicates that the monument found is the correct perpetuation of this corner. For additional information concerning this corner please contact Westwood Professional Services.

[Handwritten signature]
2/1/2018