

S1/4  
sec 4  
104N  
42W

COPY

Index E-11

# CERTIFICATE OF LOCATION OF GOVERNMENT CORNER

NORTH QUARTER Corner of Section 9, Township 104N, Range 42W

5th Principal Meridian, State of Minnesota, County of Nobles.

At the corner location shown on the sketch:

On 12/27/2017 found a NOTHING.  
DATE

left monument as found       lowered monument       removed monument (explain)

On 12/27/2017 placed a 1/2" REBAR WITH LS 49563 CAP DOWN 0.4" AT ULTEIG'S POSITION FROM  
DATE 2006.

### SKETCH OF REFERENCE TIES

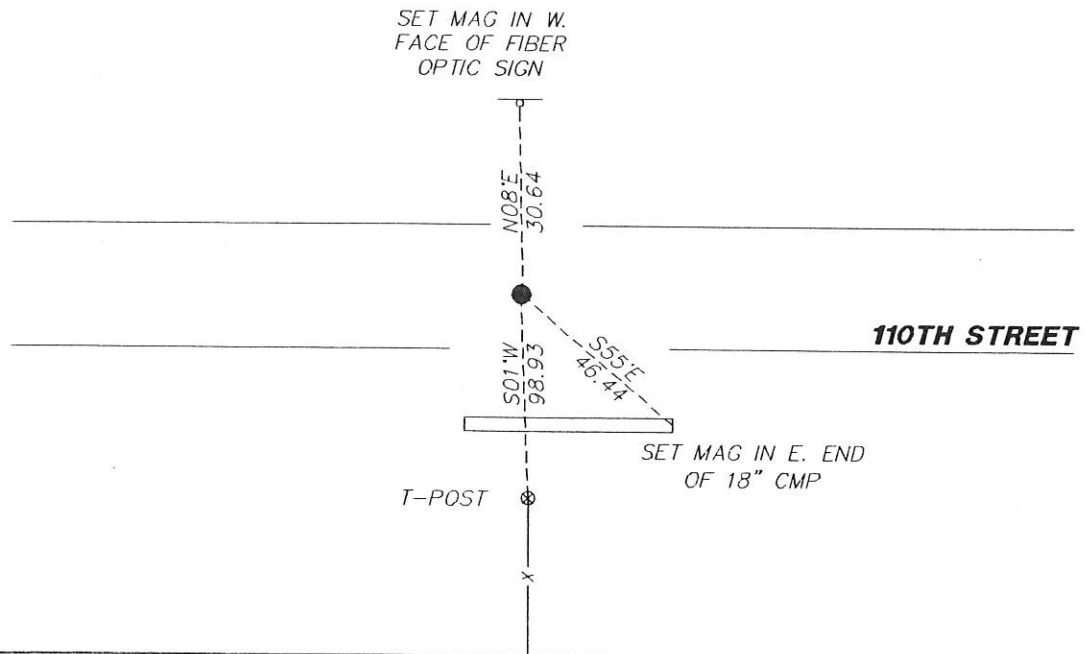

Statement of evidence for this corner location is on back of this page.

I hereby certify that this document was researched and prepared by me or under my direct supervision and that I am a licensed Land Surveyor under the laws of the State of Minnesota.

Signature TSWL

Date 2/7/18 License No. 49563

Title:

- Land Surveyor       Professional Engineer
- County Surveyor       County Engineer

DOCUMENT NUMBER A 357481  
Certified, Filed and/or Recorded on  
March 06 2018 11:05 AM

*Lynn M. Wilson*

NOBLES COUNTY RECORDER  
LYNN M. WILSON  
507-295-5268

Pages: 2

**Statement of Evidence:**

E-11

North Quarter Corner of Section 9, Township 104 North, Range 42 West, 5<sup>th</sup> Principal Meridian, Nobles County, Minnesota.

1868-Deputy Surveyor set a post in mound with pits

1900- Nobles County Highway Department "Corner Ties Book" calls for a stone set to mark the corner location.

1937 - Nobles County Highway Department "Corner Ties Book" calls for a stone to mark the corner location

2006 - Ulteig Engineers set a 5/8" rebar with LS cap 44563 on centerline and a fence line to the south, set ties, and file a Certificate of Location doc. no. 311302

2017- Westwood Professional Services located centerline and a fence line to the south and ties from the 2006 Certificate of Location. The 2006 rebar was not in place. A 5/8" rebar capped 49563 was placed per ties from the 2006 Certificate. Ties were found or set as shown on the front of this certificate

Analysis of the recovered data, field evidence and survey measurements, indicates that the monument found is the correct perpetuation of this corner. For additional information concerning this corner please contact Westwood Professional Services.

*[Handwritten signature]*  
8/1/15