

SW
Sec 24
104 42

COPY

Index R-21

CERTIFICATE OF LOCATION OF GOVERNMENT CORNER

NORTHEAST Corner of Section 26, Township 104N, Range 42W

5th Principal Meridian, State of Minnesota, County of Nobles.

At the corner location shown on the sketch:

On 11/29/2017 found a IRON PIPE CAPPED LS 44563, ON CENTERLINE INTERSECTION.
DATE

left monument as found lowered monument removed monument (explain)

On _____ placed a _____
DATE

SKETCH OF REFERENCE TIES

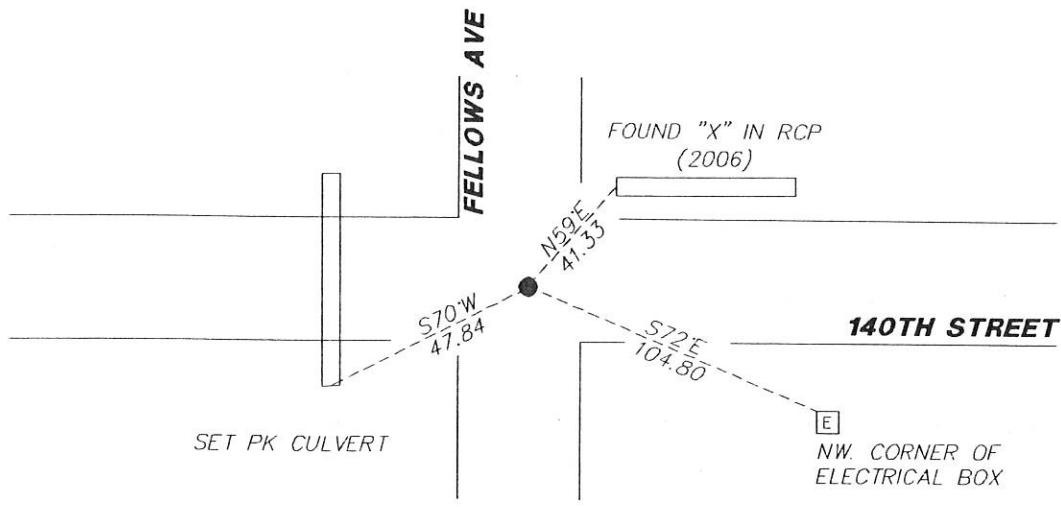

N.T.S.

Statement of evidence for this corner location is on back of this page.

I hereby certify that this document was researched and prepared by me or under my direct supervision and that I am a licensed Land Surveyor under the laws of the State of Minnesota.

Signature Lynn M. Wilson

Date 2/7/18 License No. 49563

Title:

- Land Surveyor Professional Engineer
- County Surveyor County Engineer

DOCUMENT NUMBER A 357521
Certified, Filed and or Recorded on
March 07, 2018 8:40 AM

Lynn M. Wilson

NOBLES COUNTY RECORDER
LYNN M. WILSON
507-295-5268

Pages: 2

KRIS WROOLIE
Minnesota License No. 49563

Statement of Evidence:

R-21

Northeast Corner of Section 26, Township 104 North, Range 42 West, 5th Principal Meridian, Nobles County, Minnesota.

1868-T.B. Walker set a post in mound with pits for the section corner.

1901- Nobles County Highway Department "Corner Ties Book" calls for a stone to mark the corner location.

1937- Nobles County Highway Department "Corner Ties Book" calls for a stone to mark the corner location.

2000- Madsen Land Surveying recovered a stone down 23", set an iron pin on the south side of the stone and set a 3/4" pipe over the stone and set ties

2006 - Ulteig Engineering did not find anything and set the corner with a monument capped 44563, set 3 ties, and filed a Certificate of Location doc. no. 311325

2017- Westwood Professional Services recovered pipe with LS cap 44563 and 1 tie from the 2006 Certificate. Ties were found or set as shown on the front of this certificate.

Analysis of the recovered data, field evidence and survey measurements, indicates that the monument found is the correct perpetuation of this corner. For additional information concerning this corner please contact Westwood Professional Services.

Handwritten signature and date:
Kris Wroolie
3/1/18