

W 1/4 sec 10 104 42

COPY

Index G-13

CERTIFICATE OF LOCATION OF GOVERNMENT CORNER

EAST QUARTER Corner of Section 9, Township 104N, Range 42W

5th Principal Meridian, State of Minnesota, County of Nobles.

At the corner location shown on the sketch:

On 12/04/2017 found a PK NAIL WITH A 3/8" REBAR UNDER IT AT ROAD CENTERLINE AND FENCE LINES EAST AND WEST.

left monument as found lowered monument removed monument (explain)

On _____ placed a _____
DATE

SKETCH OF REFERENCE TIES

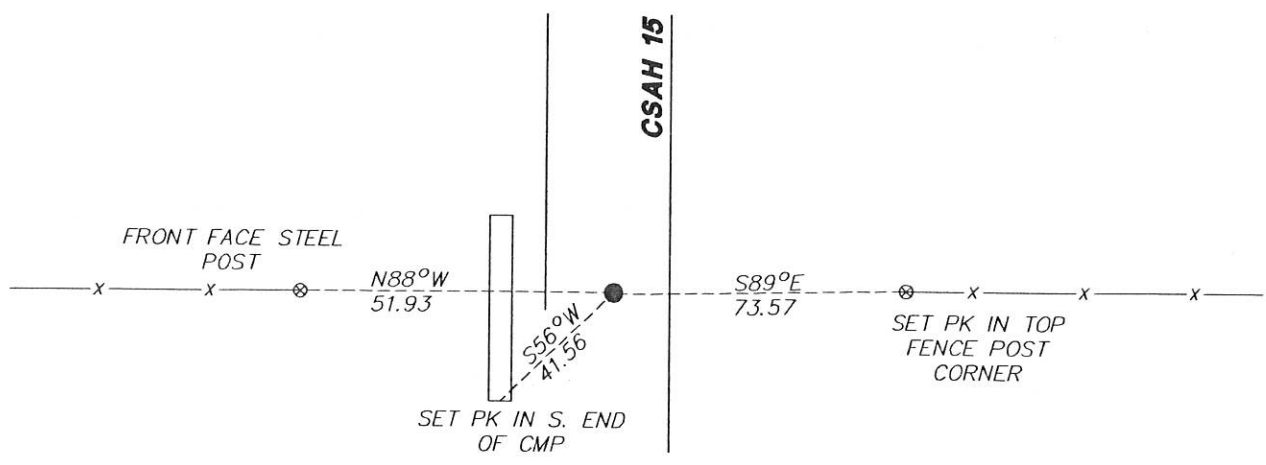

N.T.S.

Statement of evidence for this corner location is on back of this page.

I hereby certify that this document was researched and prepared by me or under my direct supervision and that I am a licensed Land Surveyor under the laws of the State of Minnesota.

Signature Lyn M. Wilson

Date 2/7/18 License No. 49563

Title:

- Land Surveyor Professional Engineer
- County Surveyor County Engineer

OFFICE OF THE COUNTY RECORDER
DOCUMENT NUMBER A 357480
Certified, Filed and/or Recorded on
March 06, 2018 11:00 AM

Lyn M. Wilson

NOBLES COUNTY RECORDER
LYNN M. WILSON
507-295-5288

Statement of Evidence:

G-13

East Quarter Corner of Section 9, Township 104 North, Range 42 West, 5th Principal Meridian, Nobles County, Minnesota.

1868-Deputy Surveyor set a post in mound with pits.

1900- Nobles County Highway Department "Corner Ties Book" calls for a stone to mark the corner location.

1980- Nobles County Highway Department "Corner Ties Book" calls for a stake and iron pin to mark the corner location.

1996 - Nobles County Highway Department "Corner Ties Book" states that an iron pin was set and a 1 3/4" PK was set.

2016 - Nobles County Highway Department "Corner Ties Book" states that a PK nail was set after an overlay.

2017- Westwood Professional Services recovered a PK with a 3/8" rebar under it at the road centerline and fence lines east and west. Ties were found or set as shown on the front of this certificate

Analysis of the recovered data, field evidence and survey measurements, indicates that the monument found is the correct perpetuation of this corner. For additional information concerning this corner please contact Westwood Professional Services.

[Handwritten signature]
2/1/18