

CERTIFICATE OF LOCATION OF GOVERNMENT CORNER

EAST 1/4 _____ Corner of Section 26, Township 104, Range 42, 5TH P.M.

STATE OF MINNESOTA, County of _____ NOBLES _____

At the corner location shown on the sketch :

On 2/21/2006 found A 1" IRON PIPE ON TOP OF CULVERT.

left monument as found, lowered monument, removed monument (explain)

On _____ set _____

Sketch of reference ties

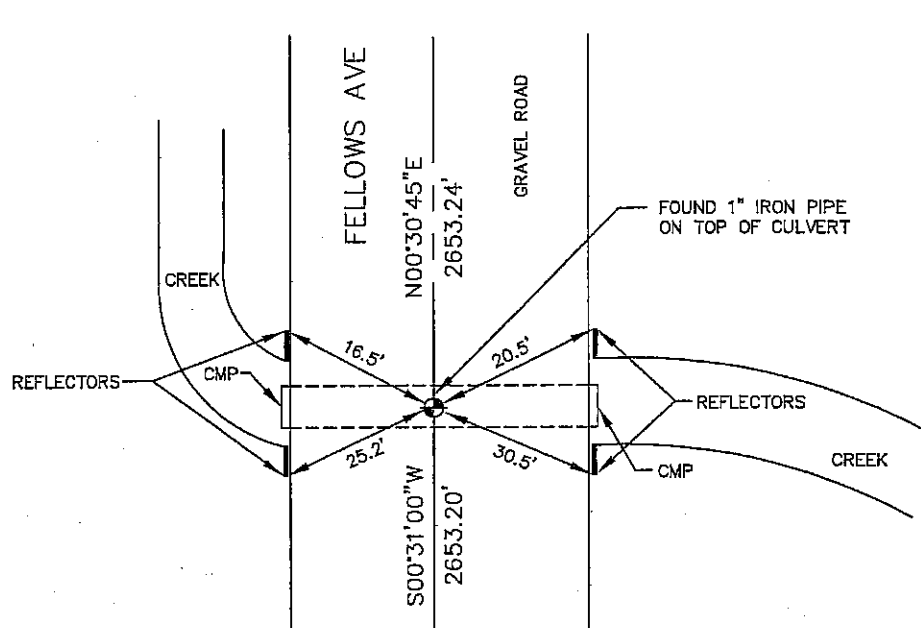

N: 618,901.38
E: 2,140,790.09
MN SOUTH, NAD 83
NOT TO SCALE

Statement of evidence relative to this corner location is on back page

A35

I hereby certify that this document and the data contained herein was prepared by me or under my direct supervision.

Thomas V. Zeff 7/7/06
 Thomas V. Zeff Date
 Registration No. 44563

- Land Surveyor, Professional Engineer
 County Surveyor, County Engineer

OFFICE OF THE COUNTY RECORDER

County of _____

I hereby certify that this document was filed in the Co. Recorders office at _____ M. on the day of _____ A.D. , 20

County Recorder _____
 By _____, Deputy

DOCUMENT NO. _____

STATEMENT OF EVIDENCE:

EAST 1/4 CORNER, SECTION 26, T. 104 N., R. 42 W.,
NOBLES COUNTY, MINNESOTA

1868 Jewett & Howe, US. Deputy Surveyors, monumented corner.

2/21/2006 Ulteig Engineers, Inc., Survey Crew, Brian Payne Party Chief,
found a 1" iron pipe in the C/L of a gravel road, on top of a
corrugated metal pipe, culvert.

Ties: NE-20.5' to N edge of bridge reflector;
SE-30.5' to S edge of bridge reflector;
SW-25.2' to S edge of bridge reflector;
NW-16.5' to N edge of bridge reflector.
N-2653.24' to NE corner, Section 26;
S-2653.20' to SE corner, Section 26.