

## CERTIFICATE OF LOCATION OF GOVERNMENT CORNER

WEST 1/4 Corner of Section 11, Township 104, Range 42, 5TH P.M.

STATE OF MINNESOTA, County of NOBLES

At the corner location shown on the sketch :

- On 2/22/2006 found A REBAR WITH AN UNREADABLE CAP IN THE  
C/L OF ROAD, OPPOSITE FENCE LINES RUNNING EAST & WEST.  
 left monument as found,  lowered monument,  removed monument (explain)
- On \_\_\_\_\_ set \_\_\_\_\_

Sketch of reference ties

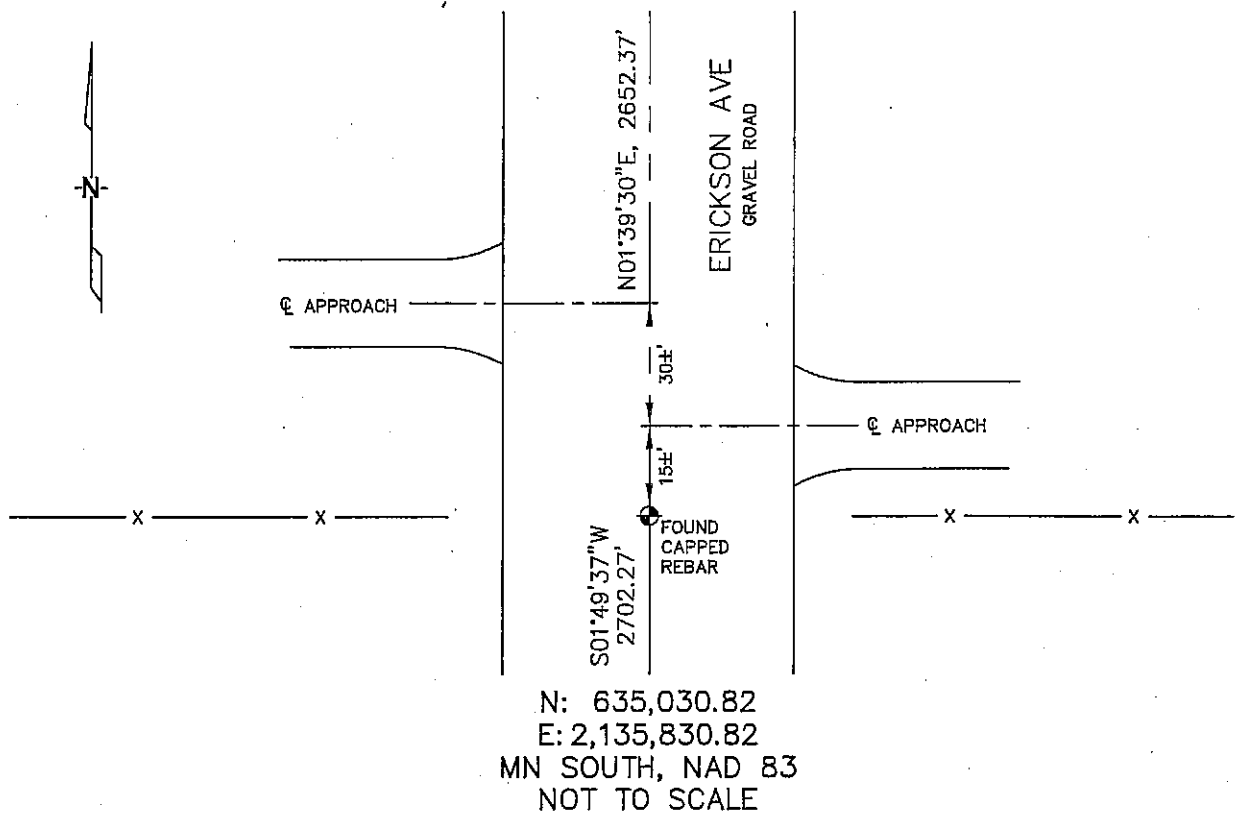

Statement of evidence relative to this corner location is on back page

I hereby certify that this document and the data contained herein was prepared by me or under my direct supervision.

Thomas J. Zeff 7/6/06  
 Thomas J. Zeff Date

- Registration No. 44563
- Land Surveyor,  Professional Engineer  
 County Surveyor,  County Engineer

### OFFICE OF THE COUNTY RECORDER

County of \_\_\_\_\_

I hereby certify that this document was filed in the Co. Recorders office at \_\_\_\_\_ M. on the \_\_\_\_\_ day of \_\_\_\_\_ A.D. , 20

County Recorder \_\_\_\_\_  
 By \_\_\_\_\_, Deputy

DOCUMENT NO. \_\_\_\_\_

STATEMENT OF EVIDENCE:

WEST 1/4 CORNER, SECTION 11, T. 104 N., R. 42 W.,  
NOBLES COUNTY, MINNESOTA

- 1868 Jewett & Howe, US. Deputy Surveyors, monumented corner.
- 1891 Nobles Co., found stone on corner, no ties.
- 1938 Nobles Co., reestablished corner and placed stake on corner, no ties.
- 2/22/2006 Ulteig Engineers, Inc., Survey Crew, Brian Payne Party Chief, found a rebar with an unreadable cap in the C/L of road, opposite fence lines running east & west.  
Ties: N-15'± to C/L of field approach to the east;  
N-45'± to C/L of field approach to the west;  
N-2652.37' to NW corner, Section 11;  
S-2702.27' to SW corner, Section 11.